



# Operator's Manual

## Roller brush SVX



**Important!**  
Please read the Operator's  
Manual before use



**TREJON FÖRSÄLJNINGS AB**  
Företagsvägen 9  
SE-911 35 VÄNNÄSBY  
SWEDEN  
Tel: + 46 (0)935 39 900  
Webb: trejon.se





## ■ INNEHÅLLSFÖRTECKNING

<b>1</b>	<b>Introduction .....</b>	<b>7</b>
1.1	Generally.....	7
1.2	Description of SVX roller brush .....	7
1.3	Detailed description.....	8
1.4	Technical data.....	9
1.5	Sweeper with floating movement.....	11
1.6	Shock absorber adjustment.....	11
1.7	Horizontal oscillation .....	12
1.8	Quick coupler .....	13
1.9	Blank connecting plates .....	14
1.10	Trejon Quick Coupler – Table .....	15
1.11	Parking Stand.....	18
1.12	Safety precautions.....	19
1.13	Safety symbols .....	22
<b>2</b>	<b>Using the Machine.....</b>	<b>23</b>
2.1	Assembly .....	23
2.2	Attaching the roller brush to the tool carrier .....	23
2.3	Overview of hydraulics .....	24
2.3.1	4-hose NO ELECTRIC.....	25
2.3.2	2-hose - 12V or 24V.....	25
2.4	Hydraulic connection overview .....	26
2.5	Sweeper Control - Installation .....	27
2.6	Control Box Function Description .....	28
2.7	Electric diagram .....	29
2.8	Check the following before use .....	30
2.8.1	Directions .....	31
2.8.2	Reversing brushing (reverse direction of rotation).....	32
2.9	Overview of the irrigation system.....	33
2.10	Use of the irrigation system .....	33
2.11	Water Pump Function Description .....	34
2.11.1	Status of water pump LEDs and error codes.....	35
2.12	Road transport.....	37
2.13	Disconnection of roller brush .....	37
<b>3</b>	<b>Service and Maintenance.....</b>	<b>38</b>
3.1	Generally.....	38
3.2	Maintenance schedule .....	39
3.3	Before the start of the season .....	40
3.4	After the end of the season .....	40
3.5	Oil change– chain drive housing .....	41
3.6	Inspection and maintenance of the chain. ....	42
3.7	Adjusting the chain tension.....	42
3.8	Replacing the chain.....	43
3.9	Changing lamellas.....	45
3.10	Removing the brush drum.....	47
3.11	Lubrication Points - Placement .....	48
<b>4</b>	<b>Spare parts .....</b>	<b>49</b>
4.1	Use original spare parts .....	49
	<b>EC certificate of conformity.....</b>	<b>50</b>
<b>5</b>	<b>Guarantee assignment certificate .....</b>	<b>51</b>

# SAFETY SYMBOLS

NB! This warning symbol can be found throughout this operator's manual and is intended to alert you to the safety instructions for yourself, your employees and other persons who come into contact with the tool. Failure to follow these instructions can result in serious injury and even death.

This symbol means the following:



**WARNING!**  
**LOOK OUT!**  
**YOUR SAFETY IS AT RISK!**

## Words of Warning

Pay attention to the warning words **WARNING!** and **NOTE!** in security texts. The words have been chosen on the basis of the following guidelines:



**WARNING!** Highlight dangerous situations that, if not avoided, could result in serious injury and even death. These also include hazards that can happen when protective equipment and/or protective screens are removed. The warning words can also be used to warn of dangerous use.



**NB!** Highlight risky situations where slight or minor injury could result if not avoided. Also used to warn that machine damage may occur if the instructions are not followed.

Dear customer,

We thank you for choosing a TREJON OPTIMAL product and hope you will be satisfied.

By reading the operating instructions and following their recommendations, you ensure the longest possible service life and efficient use of the SVX sweeper.

We have made this manual so that you can get a good overview of how the roller brush works and which safety and maintenance instructions that must be followed when working with the roller brush.

If any questions arise when using the roller brush or when reading this book, you are always welcome to contact us.

TREJON AB  
Företagsvägen 9  
SE-911 35 Vännäsby  
Sweden

Tel: + 46 (0)935 399 00

E-mail: [info@trejon.se](mailto:info@trejon.se)

Website: [www.trejon.se](http://www.trejon.se)

Dear Dealers,

In order for the warranty to come into effect and all legal requirements to be met, we ask you to fill in the warranty certificate together with the customer and register on **www.trejon.se**

The warranty comes into force on the same day that the roller brush is handed over to the customer.



Checklist for delivery inspection:

Check for any transport damage. Report to the transport company	
Inspect the tool carefully before use and check that all packing material has been removed. Dispose of the packing material in an environmentally friendly way.	
Check that the delivery is complete according to the machine order/delivery note.	
Check that the machine is lubricated, see section "Service and maintenance".	
Check the tightening of the bolted joints, see the torque table in Service and Maintenance (Chapter 3).	
Perform Functional Test	
Fill in the guarantee assignment together with the customer and register on trejon.se	
Hand over owner's manual to the customer.	

Fill in the serial number of the roller brush in the field to the right.	S/N:
--	------



**Read the entire instruction manual and understand its content before using the roller brush.**

# 1 Introduction

## 1.1 Generally

Before using the roller brush, it is strongly recommended to read the operating instructions and safety instructions carefully.

The user must be familiar with the SVX roller brush to ensure safe use.

## 1.2 Description of SVX roller brush

The SVX sweeper is modular, which means that the basic machine can easily be adapted with different accessories to suit different tool carriers and different areas of use. The frame of the sweeper is rotatable  $\pm 32^\circ$  and its pivot point is also moved back to prevent the wheels from stepping on the material. The sweeper can be used to move the material to the left, right or even directly in front of the tool carrier.

The SVX main frame is available in two versions:

1. Connection frame without water tank

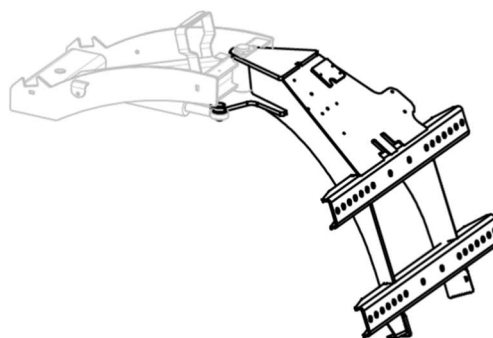
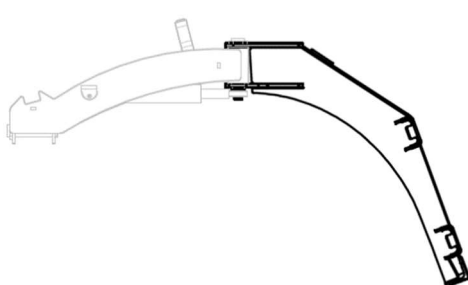

2. Connection frame with water tank

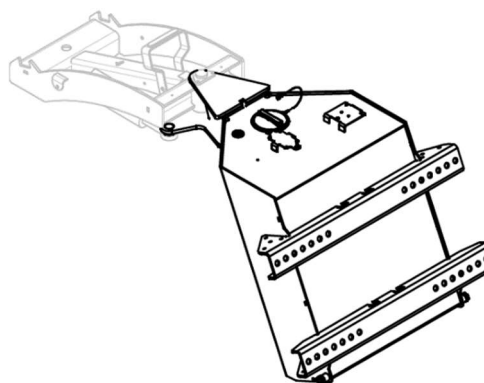
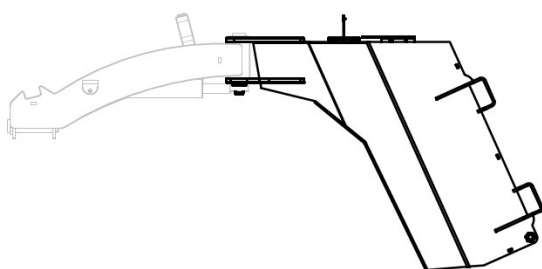

The sweeper is designed to be connected to the existing quick hitch for agricultural tractors, wheel loaders and compact tractors. The TREJON OPTIMAL SVX sweeper can be equipped with a quick connection for most tractors.

The sweeper is designed for sweeping away sand, debris and snow. The rotation speed of the roller brush is adjustable. In addition, the brush can rotate in the opposite direction (reverse direction of rotation), but in this mode only at a fixed speed. When reversing, it is done at a low fixed speed.

The roller is turned with a hydraulic cylinder that get its oil from the tool carrier's hydraulic outlet (4-hose) or by the sweeper roller operating valve (2-hose). In 2-hose configuration, an electrical activation (12V or 24V) is required to affect these electrical coils. This activation can also be controlled from the Trejon Optimal control box, which is also adapted to control a water pump.

### 1.3 Detailed description

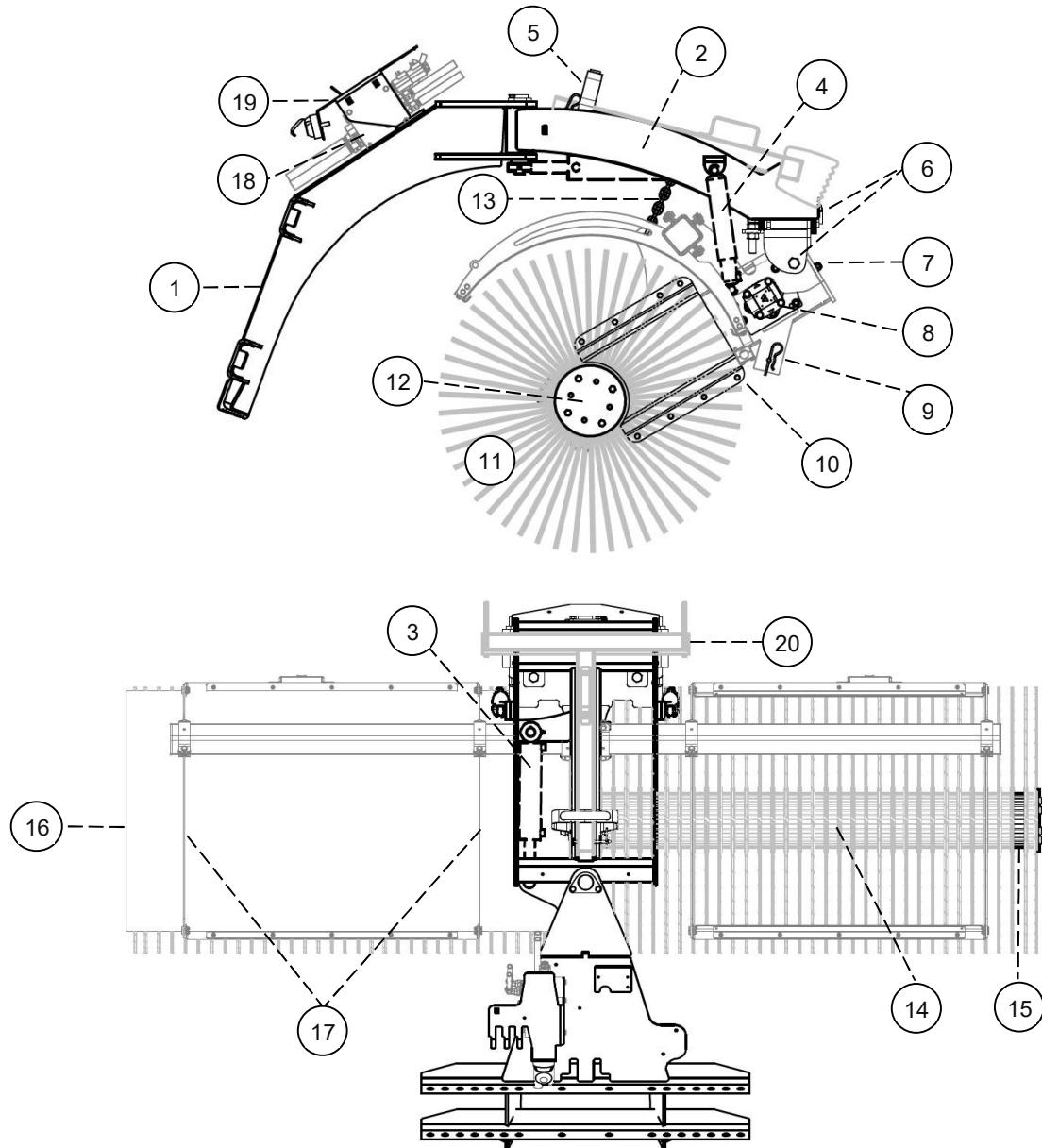

1. Connection frame	11. Lamellas/slats (ø900mm)
1.1 Integrated connection frame with galvanized water tank (option)	12. Brush drum cover cap
2. Sweeper swivel frame	13. Limitation chain with shackle
3. Swivel cylinder	14. Brush drum
4. Shock absorber, adjustable	15. Distance
5. Lifting eye and transport position for parking leg	16. Mudguard
6. Pins for vertical and horizontal float position	17. Mudguard support (bolted)
7. Chain tensioner	18. Hydraulic valve (brush speed)
8. Hydraulic motor	19. Protective cover
9. Parking assist holder	20. Parking Stand
10. Wear plate chain housing	

## 1.4 Technical data

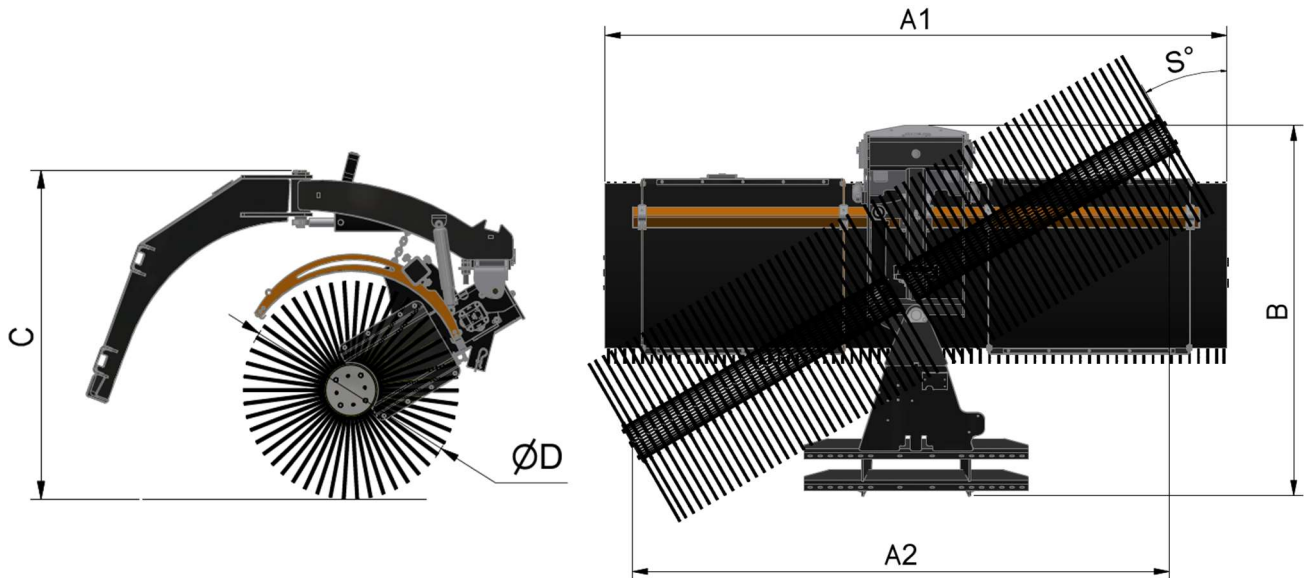

Model	SVX250	SVX280	SVX300	SVX330
Dimension A1, cm	250	280	300	330
Dimension A2, cm	212	238	255	280
Dimension B, cm	190	190	190	190
Dimension C, cm	130	130	130	130
Dimension D, cm	90	90	90	90
Turning angle S	32°	32°	32°	32°
Weight excl. quick coupler [kg]	475	500	520	550
Number of hydraulic connections	1 DV 1/2" Faster male-male	1 DV 1/2" Faster male-male	1 DV 3/4" TEMA female-female	1 DV 3/4" TEMA female-female
Recommended flow l/min	35-120	55-120	55-120	55-120
Oil pressure (min-max) bar	160-230	160-230	160-230	160-230
Recommended machine weight, tons	>3	>4	>4	>4

Due to ongoing product development, the technical data provided in our documents is not binding and is subject to change without notice. Given information in the table above may also show equipment that is not standard. Equipment level may vary depending on the country of use.

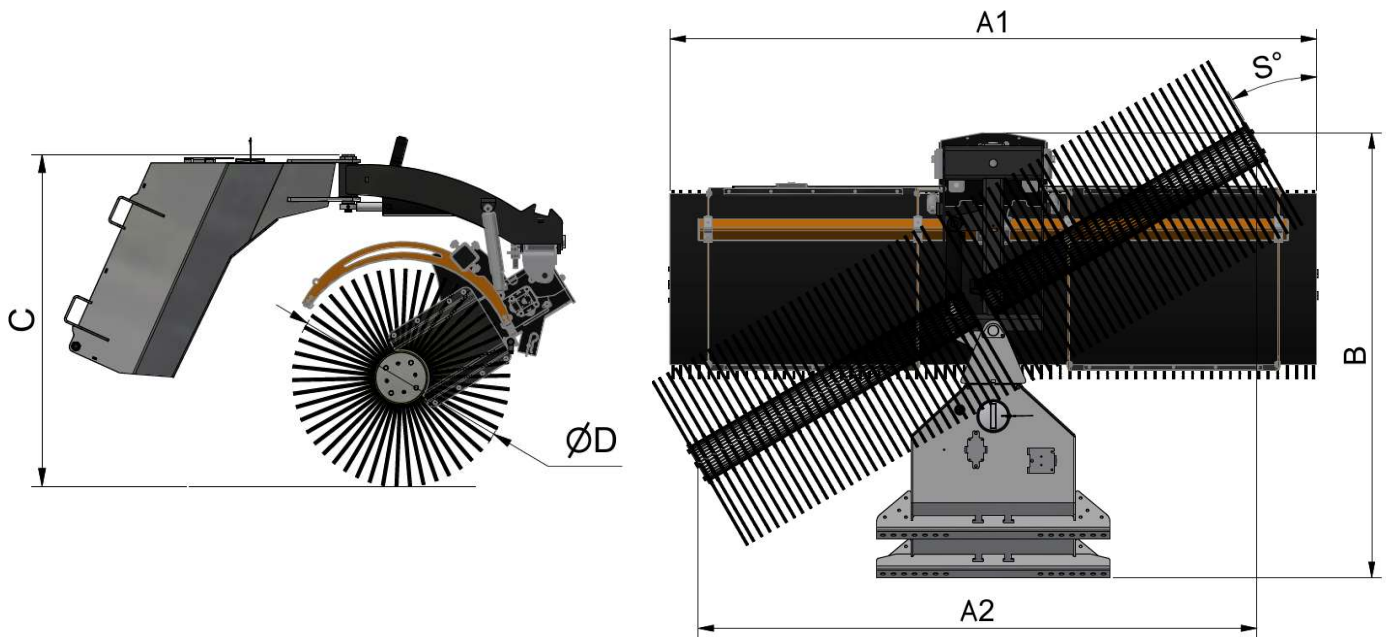

Model	SVX250W	SVX280W	SVX300W	SVX330W
Dimension A1, cm	250	280	300	330
Dimension A2, cm	212	238	255	280
Dimension B, cm	210	210	210	210
Dimension C, cm	130	130	130	130
Dimension D, cm	90	90	90	90
Turning angel S	32°	32°	32°	32°
Weight excl. quick coupler [kg]	600	615	675	700
Number of hydraulic connections	1 DV ½" Faster male-male	1 DV ½" Faster male-male	1 DV ¾" TEMA female-female	1 DV ¾" TEMA female-female
Recommended flow l/min	35-120	55-120	55-120	55-120
Oil pressure (min-max) bar	160-230	160-230	160-230	160-230
Recommended machine weight, tons	>3	>4	>4	>4

Due to ongoing product development, the technical data provided in our documents is not binding and is subject to change without notice. Given information in the table above may also show equipment that is not standard. Equipment level may vary depending on the country of use.

### 1.5 Sweeper with floating movement

The position bracket is movable for vertical oscillation as well as swivel (horizontal) (see pictures. 1; 2; 3 below for a description of the range of motion).

The movement of the sweeper is limited vertically upwards by stop screws (A) according to the picture. 1 and vertically downwards of the chain (B) according. Picture.2. Total movement up and down is approx. 120 mm. Picture.3.

It is important to position the float bracket so that it can move freely both up and down. See level (C) on Picture.3.

Lower the roller brush so that it touches the ground. Lower the quick coupler bracket further about 60-70mm. In this position (float position), the sweeper is given the opportunity to follow the surface in the best way, reduce wear on the slats and provide a good sweeping result.

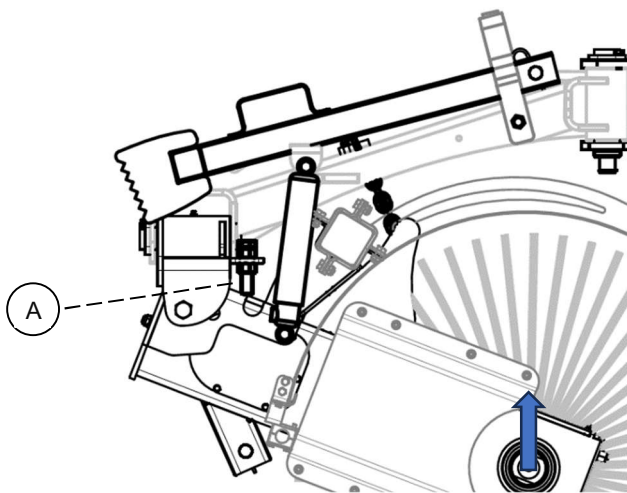

Picture.1 – Vertical movement up (End position).

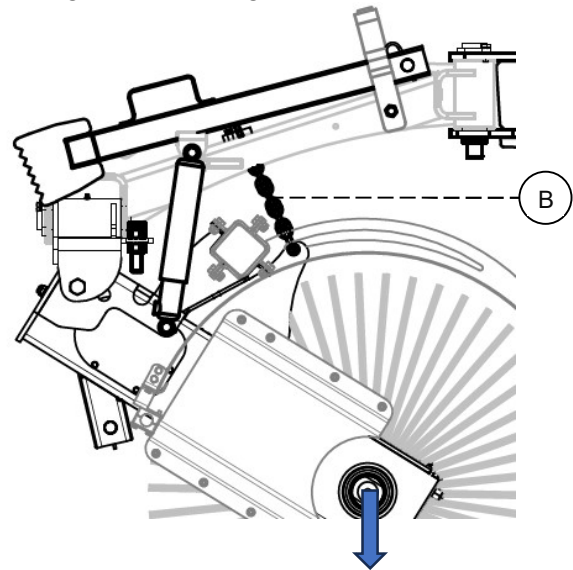

Picture.2 – Vertical movement down.

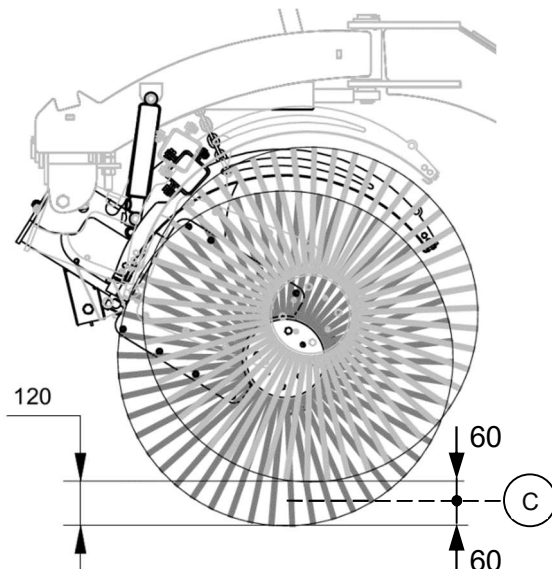

Picture.3 – Float position

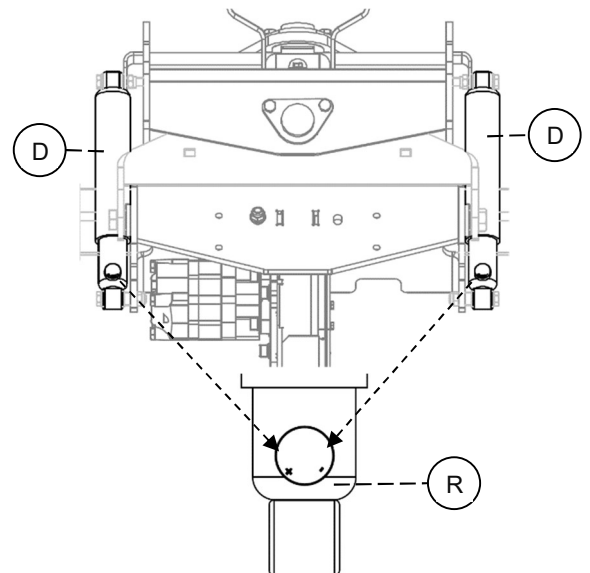

Picture.4 – Shock absorber adjustment, basic setting is 5 "clicks" from fully closed.

### 1.6 Shock absorber adjustment.

To provide a calmer and more stable operation, the sweeper is equipped with two shock absorbers (D) (part number. **SOP980247**). The degree of damping can be adjusted, a basic adjustment of this is done by turning the knob (R) by hand on the damper (D) until it is completely closed. After this, the knob opens 5 "click" positions on both dampers - see Picture.4.

## 1.7 Horizontal oscillation

The sweeper also has a horizontal oscillation. This means that the brush will adapt to the ground regardless of the angle of the tool carrier. The movement is +/- 4 degrees. The oscillation of the brush is mechanically limited in the frame and can NOT be adjusted. See Picture.5.

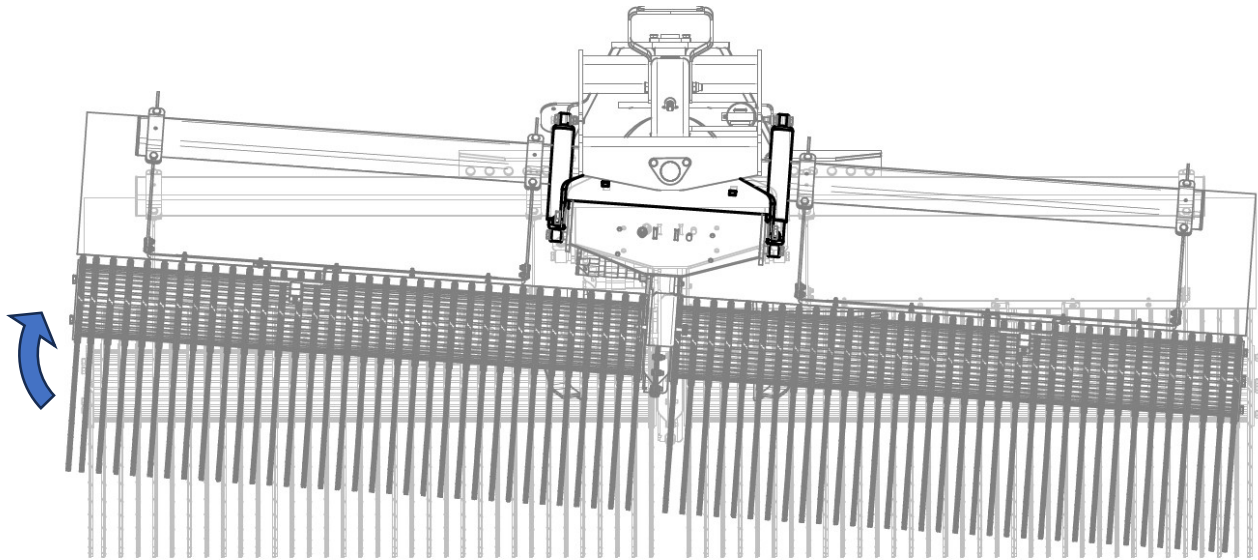

Picture.5

### 1.8 Quick coupler

The type of quick coupler / hook (1) against the quick coupler (3) or suspension of the tool carrier must always be specified when ordering the SVX sweeper. See Picture.6 for the names of the different parts. It is important to use the correct tightening torque; **M20 (420Nm)** and **M16 (215Nm)** for all bolts (4) when mounting the quick coupler / hook (1) to the sweeper coupling frame (2). Clutch frame holding picture – see Picture.7.

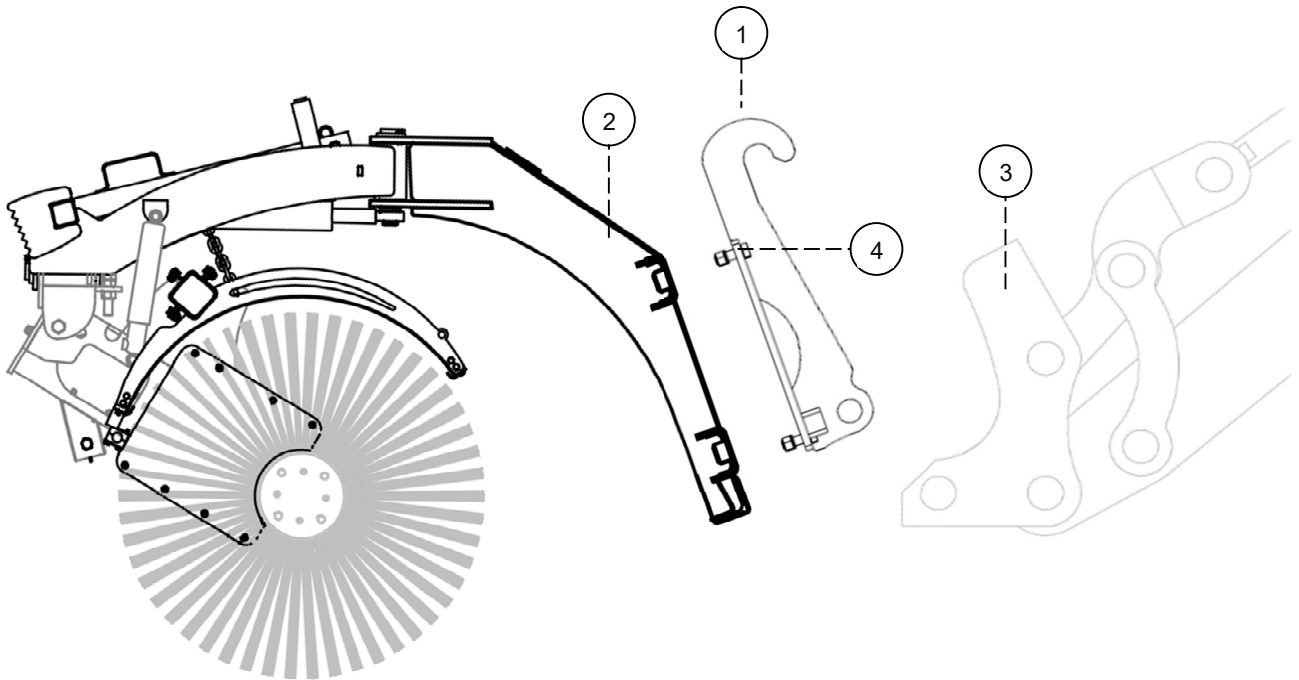

Picture.6

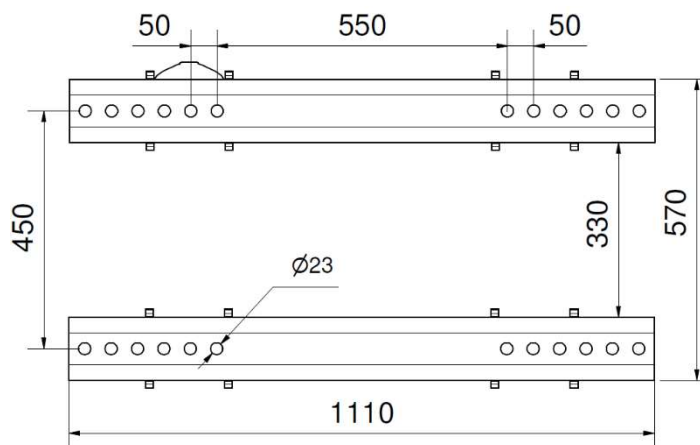

Picture.7 – Hold view.



**Warning!**  
Loose or poorly tightened bolts may cause the roller brush to loosen and cause material and/or injury!

### 1.9 Blank connecting plates

There are many different tool carriers, in cases where Trejon does NOT have a ready-made bracket, you can weld these yourself to a blank plate (A). There is a ready-made kit for this, **part number. 84005** – see Picture.8. The customer can weld fastening hooks for the load carrier themselves. For installation with SVX roller brush, read section 1.8.



**Warning!**

It is the person who welds/manufactures the bracket who is responsible for any incorrect welding/manufacturing that can lead to future damage or accidents.

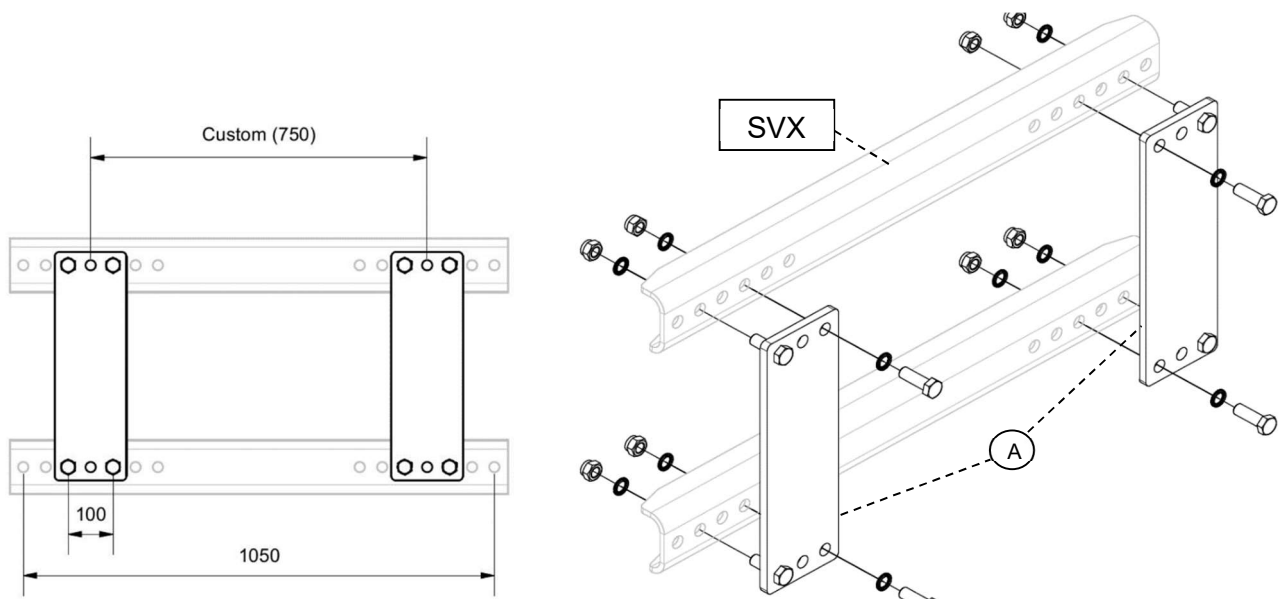

Picture.8

### 1.10 Trejon Quick Coupler – Table

The SVX sweeper can be equipped with different quick couplers. The table below shows Trejon code no. of the most viable. All of these fit the SVX rotary broom coupling frame.

Model	Set Code no.	C-C [mm] (inside)	Picture	Location of the stop lug (ST)	Other
Volvo BM	<b>450010</b>	960	9.1	Outside	-
3-point Kat.2-3N	<b>440109*</b>	825	9.2	-	Wider ( <b>W</b> ) side inwards
Trima/SMS	<b>450075</b>	650	9.3	-	Wider ( <b>W</b> ) side inwards
Euro	<b>450084</b>	995	9.4	Outside	-
Zettelmeyer 502-702	<b>60565</b>	860	9.5	Inside	-
Zettelmeyer 402	<b>60131</b>	650	9.6	Inside	-
Bobcat	<b>60117</b>	590	9.7	-	-
Kramer	<b>450083</b>	862	9.8	Inside	-
Kramer 8115	<b>60461</b>	872	9.9	Inside	-
Kramer 880	<b>60439</b>	870	9.10	-	Wider ( <b>W</b> ) side inwards
Push rod Kat II L= 635-920*	<b>2023021</b>			-	Required for front mounting

\*When using a 3-point front linkage, a longer push rod is usually required, Part number 2023021

It is important to maintain dimensions C-C (see Picture.9) when installing quick couplers. Placement of the stop lug (ST) is also an important part of assembly.

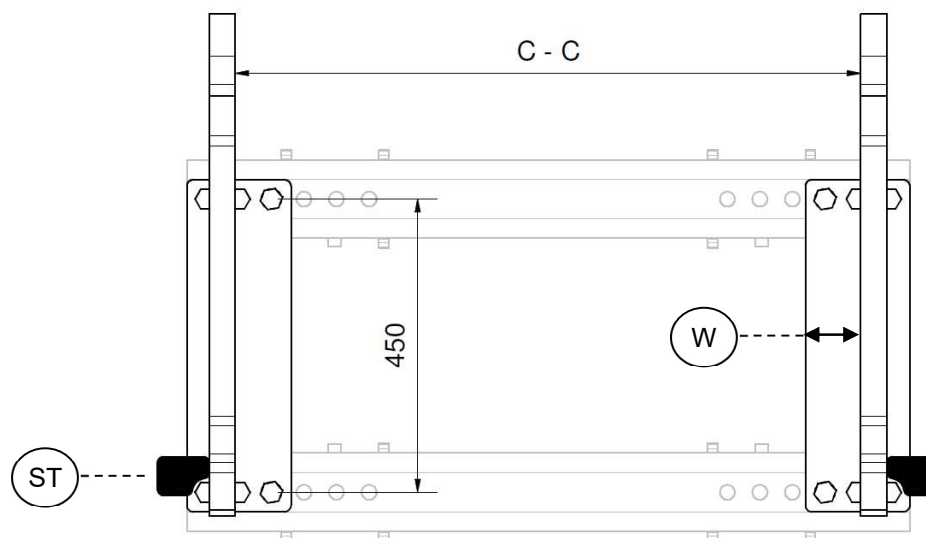

Picture.9

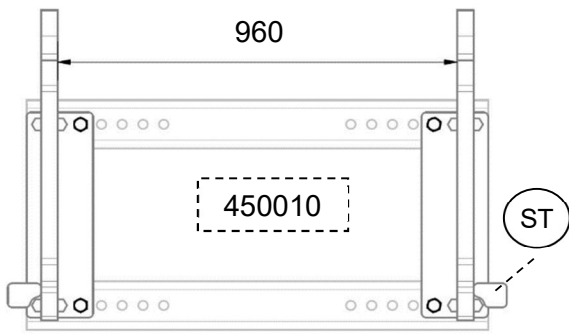

Picture.9.1 Volvo BM

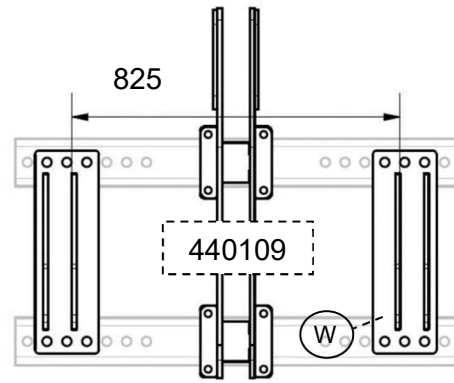

Picture.9.2 3-point Kat.2-3N

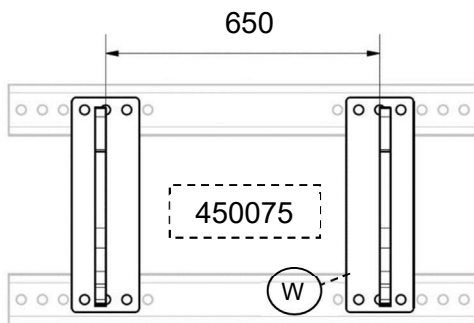

Picture.9.3 Trima/SMS

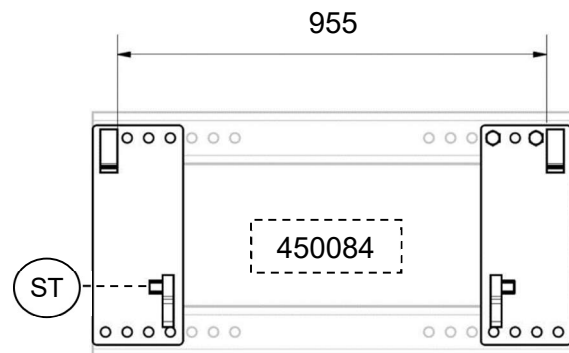

Picture.9.4 Euro

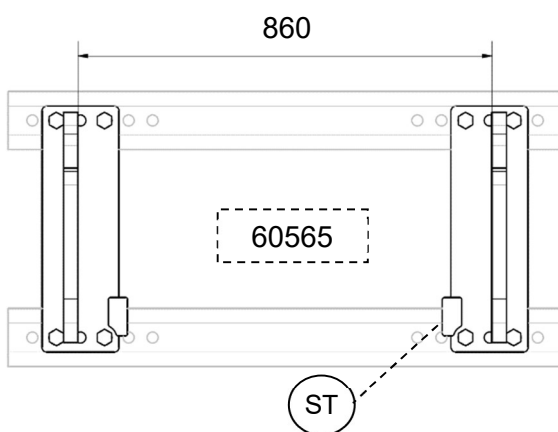

Picture.9.5 Zettelmeyer 502-702

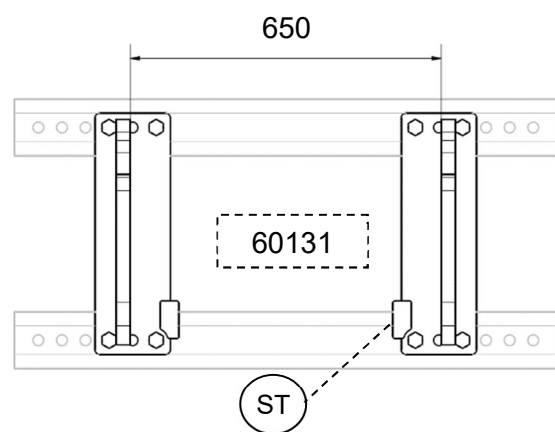

Picture.9.6 Zettelmeyer 402

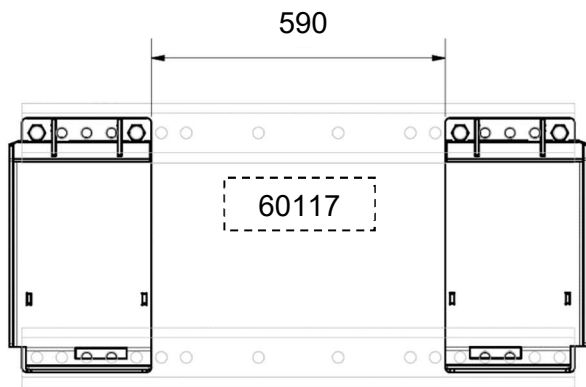

Picture.9.7 Bobcat

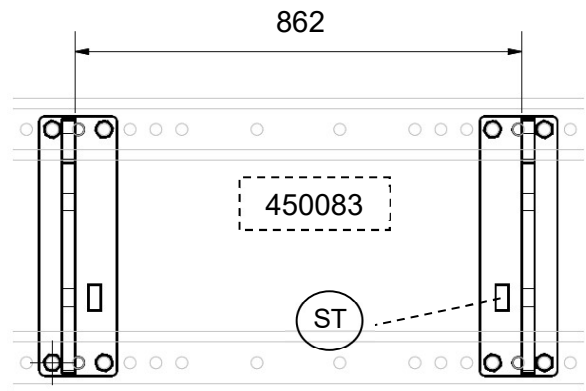

Picture.9.8 Kramer

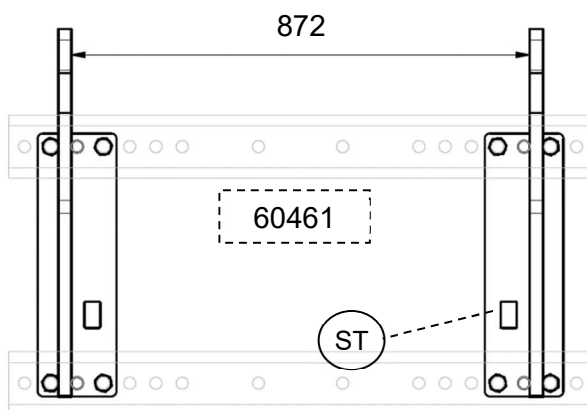

Picture.9.9 Kramer 8115

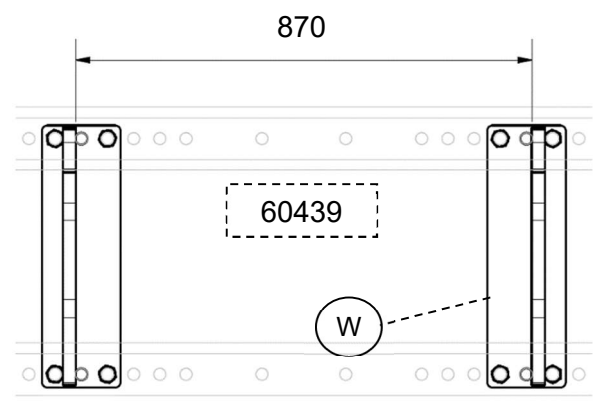

Picture.9.10 Kramer 880

### 1.11 Parking Stand

When unhooking the sweeper, use the parking stand (A) located on the swing frame (S) (see Picture.12). Insert the parking stand (A) into the profile (F), securing it with the locking pin (B) and the R pin (C) (see Picture.10). To prevent deformation of the roller brush and its lamellas, this is a prerequisite that they do not reach the ground  $X > 0$ , see Picture.11. Before lowering the machine to the ground, open the locking pins on the quick coupler of the implement carrier in order to reduce the pressure on the parking stand.

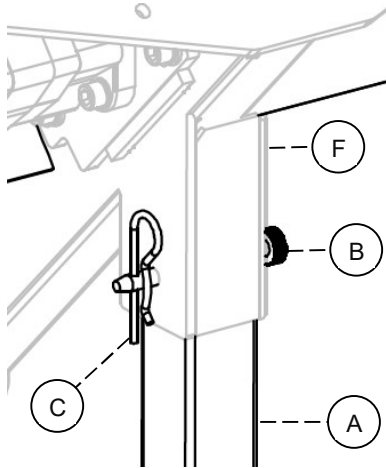

Picture.10

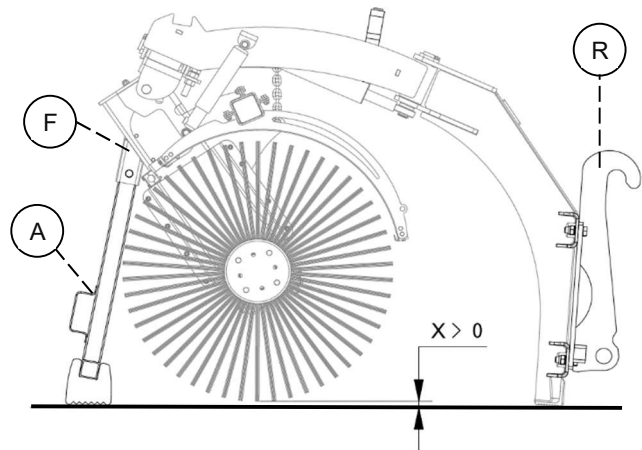

Picture.11

After attaching on the sweeper, place the parking stand (A) in the swing frame (S) so that the profile tube of the parking stand locks in the swing frame (S), recess (T) and under the mounting plate (L), see Picture.12). The locking pin (B) and the R pin (C) must be placed in the parking stand (see Picture.12).

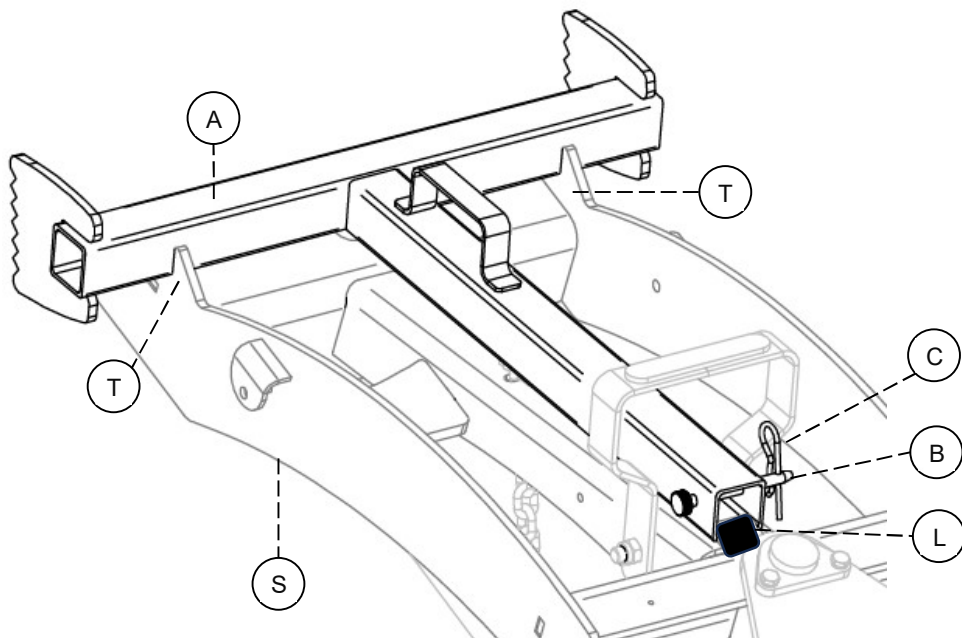

Picture.12



**OBSERVE!**

**A bent or damaged parking stand is NOT covered by any warranty.**

## 1.12 Safety precautions

**Read the user manual.** All machine operators must read and understand the contents of these operating instructions and the safety instructions in such a way that there is no ambiguity about the use of the machine/tool before it is put into use. If you have any questions, please contact your dealer.

It is forbidden to use the machine if the user is not aware of the risk factors associated with the use of the machine and is unable to act if a hazardous situation arises during use.

Read, observe and understand the meaning of all safety, use, warning and position labels on the device and in the operating instructions.

Things can happen when using this tool that cannot be prevented in the design or with mechanical protection.

Unfortunately, human negligence can nullify our built-in security measures. Thus, accident prevention and occupational safety depend on responsible use of the gear and built-in safety measures.

Only trained personnel should use the gear.

**Handling.** Learn and practice the machine's operation and controls before using it.

**Switching on the machine.** Connect the device correctly, do not stay between the tool carrier and the machine when switching it on.

Make sure that the attachment is correctly assembled, adjusted and in working order.

**Secure the work area.** Keep unauthorised persons, especially children, away from the working area of the machine or the machine being repaired.

Be aware of the risk of injury caused by materials that may be thrown by the machine during operation.

Make sure that **warning and utility stickers** are in good condition and displayed correctly, if not replace them immediately. Write the model and serial number on the order.

**Moving parts.** Make sure that arms, legs or other parts of the body and clothing do not come into contact with moving parts of the machine.

**Lifting and lowering of the machine.**

Be careful when lifting and lowering the machine/part of the machine.

**Stability.** The machine must not be operated with a tool carrier that does not have sufficient weight over the front/rear axle so that the steering and stability of the tool carrier is affected. Read the tool carrier's operating instructions.

**Operation of a machine.** Be careful when working in uneven ground conditions, near ditches and fences, watch out for hidden hazards, adjust the speed of work.

Do not reverse with the roller brush down (wrong way)

When working on steep slopes, special care should be taken:

Try driving in the same direction as the slope and not across.

Avoid rapid starting and braking when the machine is going up or down slopes.

If you are forced to drive across steep slopes, reduce your speed, watch out for unevenness, avoid sharp turns and be aware of the shift in the centre of gravity that occurs when lifting the mounted implement.

If the tool carrier tips over, hold on to the steering wheel.

**Driving in the dark.** When working in the dark, the work area must be illuminated.

**Driver.** Tired, intoxicated, drugged or otherwise intoxicated persons so that they cannot control their movements, must not use the machine.

The machine may only be operated by one person, the person sitting in the tool carrier, no passengers are allowed.

It is forbidden for persons without authorisation to operate the machine.

**Personal protective equipment.** Protective equipment, such as a hard hat, goggles, safety shoes, and gloves, is recommended for personnel during assembly, operation, adjustment, and maintenance.

**Shelter.** The machine must only be operated with a tool carrier that is equipped with an approved safety cab. Keep doors and windows closed while working.

Before the driver leaves the cab, all moving parts, including the engine, must have stopped and the handbrake must be applied.

**Care.** Check, adjust and maintain the machine according to the instructions.

**Regular review.** Check the entire machine regularly. Check for loose, worn, damaged parts, as well as leaks.

**Safety during maintenance and service.** For maintenance and adjustment of the machine, it must be placed on a firm, level surface, see chapter 1.11 for more information.

The tool carrier must be switched off, all moving parts stopped, the machine lowered to the ground and the handbrake applied during all cleaning, checking, adjustment, maintenance and repair.

Clean the machine thoroughly before repair and storage.

Bearings and hydraulic components should not be cleaned with a pressure washer.

If general cleaning is done with too much pressure, the paintwork can be damaged.

After cleaning, the machine should be lubricated according to the lubrication plan, and a short test run should be carried out.

**Vibrations.** If vibration occurs in the machine, it must be switched off immediately to investigate the cause. Replace any damaged parts.

**Hydraulic hoses.** The hydraulic hoses on the machine contain oil under very high pressure. Do not touch hose and hydraulic components if there is pressure in the system. Oil under high pressure can penetrate the skin and cause serious damage in the event of leakage, in the event of an accident, contact a doctor immediately.

Check the condition of the hydraulic hoses daily for damage. Scuffed and leaking hoses should be replaced immediately with new ones that meet the manufacturer's technical requirements.

When changing tractors, always check the length of the hoses, as hoses that are too long or too short can be damaged.

It is forbidden to use faulty hydraulic hoses that do not meet the specifications.

Hoses may become hot during operation, risk of burns. Do not loosen hoses when the oil is hot, wait and allow to cool.

**Welding.** Protect bearings, hydraulics and electronic components if welding is to be carried out. Before welding, the electronic components must be disconnected while placing the weld earth clamp close to the welding site.

**Electrical wiring.** Pay extra attention when working in the vicinity of power lines, keep a safe distance with a good margin.

In the event of an accident, the roller brush comes into contact with live conductors.

Keep calm, act rationally so that the situation does not worsen, do not touch any metal parts.

Warn people nearby, make sure they stay out of the danger zone.

**Spare parts.** Use only original spare parts for the machine.

If you have any questions about the machine or its function, please contact the dealer or Trejon AB

### 1.13 Safety symbols

The symbol on the right shows the following:

	<p>Warning! Read the operating instructions carefully before use, so that the user knows the machine well.</p>	
	<p>Warning! Risk of pinching! When coupling, you must not be between the machine, machine parts and the tractor. Always brake the implement carrier, switch off the engine and remove the ignition key when leaving the cab for all coupling or disconnection work</p>	
	<p>Designated lifting point.</p>	
	<p>This is the machine plate with the CE mark. Here you will find the model designation, the machine's serial number, weight and year of manufacture.</p>	

## 2 Using the Machine

### 2.1 Assembly

The SVX sweeper is delivered attached to a pallet.

When the roller brush is to be lifted from the pallet, this can be done in two ways.

- 1) Directly to the quick coupler (A) – See Picture.13, after first installing the fastener system (read chapter 1.8)
- 2) With lifting equipment, such as chains. The lifting accessories or lifting fork are attached to the lifting eye (B) at the tip of the sweeping roller. The lifting equipment must be able to withstand a load of at least 1500kg. Make sure that the lifting chain is long enough to prevent damage to the roller brush!

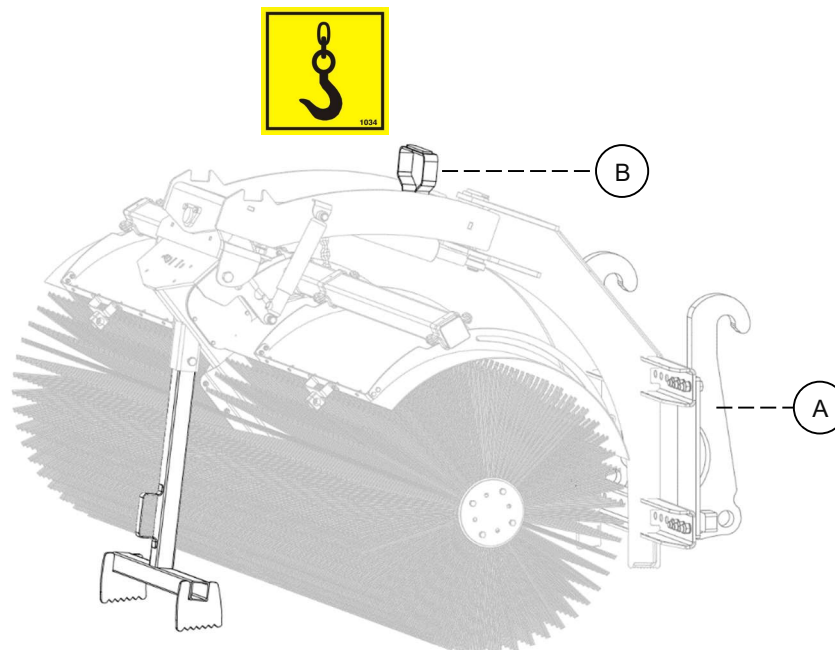

Picture.13

### 2.2 Attaching the roller brush to the tool carrier

The quick coupler of the SVX sweeper is compatible with the implement system specified when ordering the SVX sweeper.

Check that the tool carrier is suitable for mounting to the sweeper. The roller brush is attached to the front linkage/load arm of the tool carrier or loader.

- 1) Connect the SVX roller brush to the tool carrier's existing quick coupler in the same way as specified in the implement carrier operating instructions.
- 2) Switch off the tractor engine and apply the parking brake.
- 3) Check that the tool carrier's hydraulic system is depressurized. The hydraulic hoses must be routed in such a way that they are not damaged by the movement of the roller brush.
- 4) Connect the hydraulic hoses to the double-acting socket of the tool carrier, see chapter 2.3.
- 5) Check that the roller brush is free from the tool carrier when attaching the roller brush.

Always check that the quick couplings and oil are clean, and that the hoses are intact. Be extra careful during the first installation to check that the roller brush parts do not collide with the tool carrier when moving.

**The warranty does not cover damage caused by incorrect installation.**

## 2.3 Overview of hydraulics

The hydraulic valve on the SVX can handle an oil flow of MAX 120 l/min and regulate a flow to the sweeper of 0-60 l/min, **MA** port Picture.14 (see also chapter 2.8.1). As well as reversing the brush (reverse direction of rotation) with a fixed flow, **MB** port.

The sweeper hydraulic valve has different markings on its connections - see Picture.14.

### IMPORTANT!

**The plug with hexagon socket (P) - see Picture. 14, should always be removed before starting, when configuring – read installation instructions art.nr. 2020014 – Supplied with every machine.**

The hoses connected at the valve ports **PA & PB** are connected to the implement carrier's double-acting hydraulic outlet. It is a great advantage if the hydraulic function of the tool carrier can be locked in one direction. If this is the case, always the hose connected to **the PA port should be mounted so that a constant flow can be delivered on this outlet from the tool carrier.**

**PA:** Connected from the tool carrier, this drives the rotation of the brush

**PB:** Connected from the tool carrier, this drives reverse rotation (reversing) of the brush

**CA; CB** – Swivel function (swivel cylinder)

**MA; MB** – Output hydraulic motor (brush roll)



Bild.14

The SVX sweeper hydraulic valve is designed for two variants:

1. 4-hose NO ELECTRIC
2. 2-hose - 12V or 24V

### 2.3.1 4-hose NO ELECTRIC

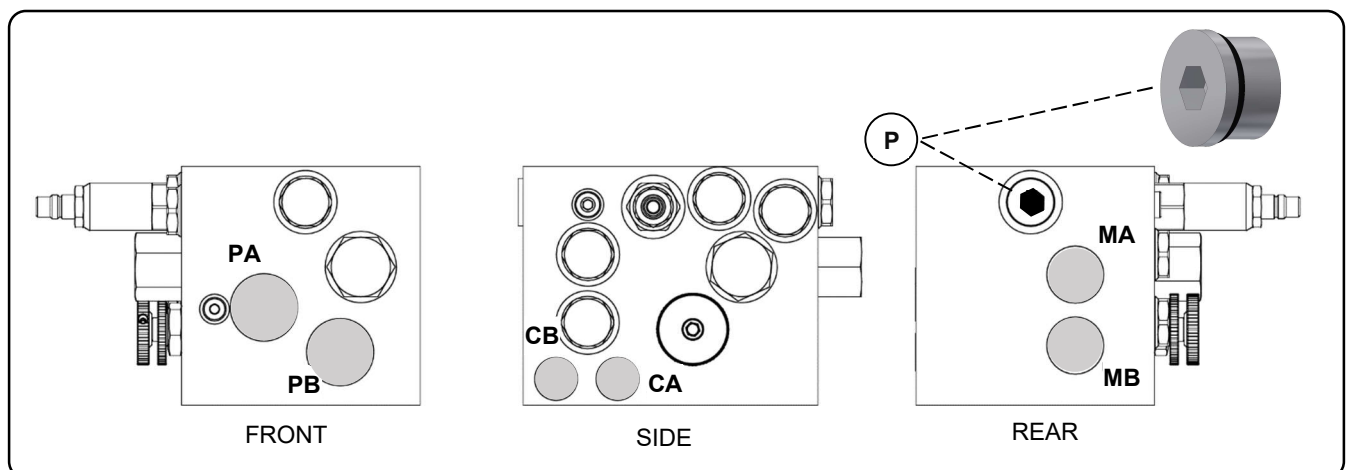
The tool carrier's 3rd (PA & PB) and 4th function (CA & CB turn) are used to control the sweeper. **NO EL** – cavitation plug (CP), mounted in the valve – see picture.15.



Bild.15

### 2.3.2 2-hose - 12V or 24V

The tool carrier's 3rd (PA & PB) function in combination with a valve cartridge, 2 electric coils (EP) (12V or 24V) – see Picture.16, and a wiring harness mounted on the sweeper – see Picture.17. These are used to control the swing function of the sweeper. More info - read installation manual art.nr. 2020014 – Supplied with every machine. In this version, the valves must be activated with the correct voltage from the tool carrier.

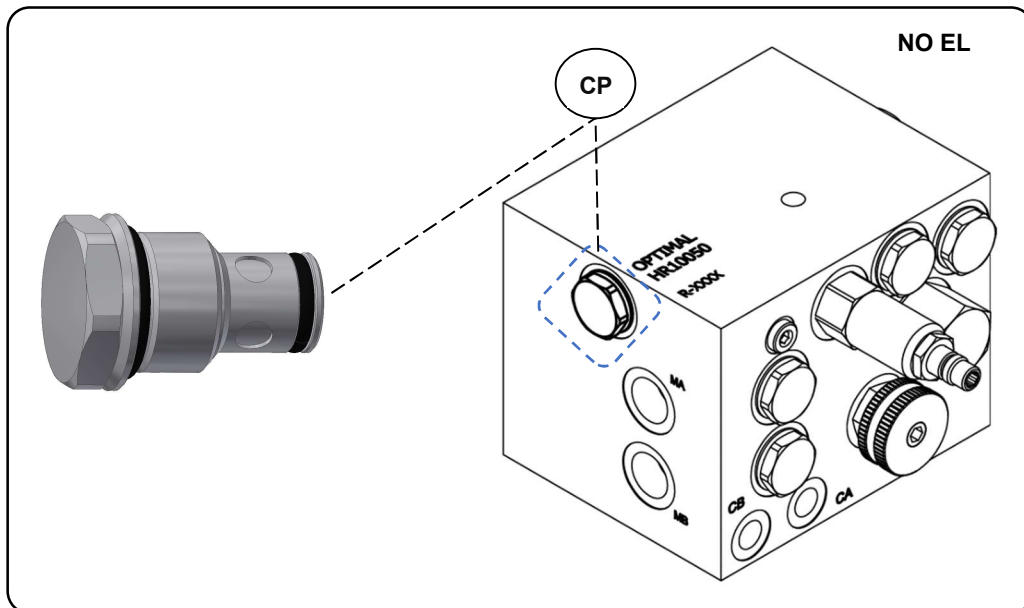

**If the roller brush is lifted off the ground, you may notice that the swing function is weak or slow. This is normal and disappears completely when the brush is lowered to the ground and a hydraulic resistance is created.**

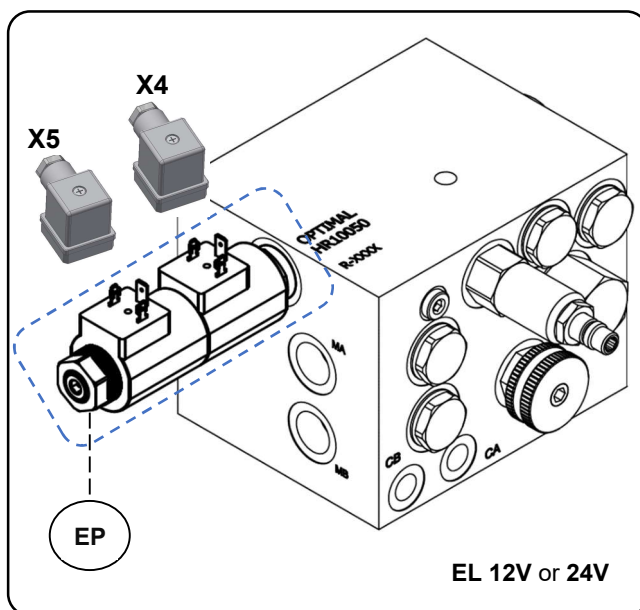

Picture.16

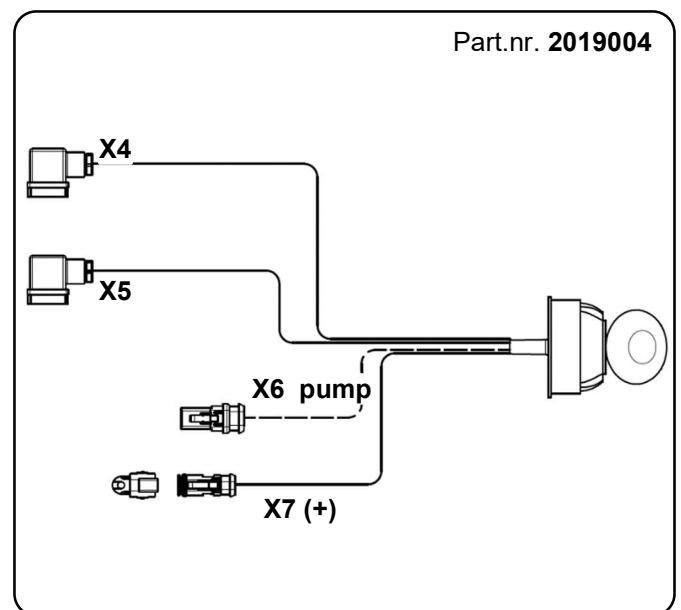

Picture.17

## 2.4 Hydraulic connection overview

The SVX sweeper's hydraulic valve (HV) is connected to the swing cylinder (SC) and the brush's hydraulic motor (HM) according. below – see Picture.18

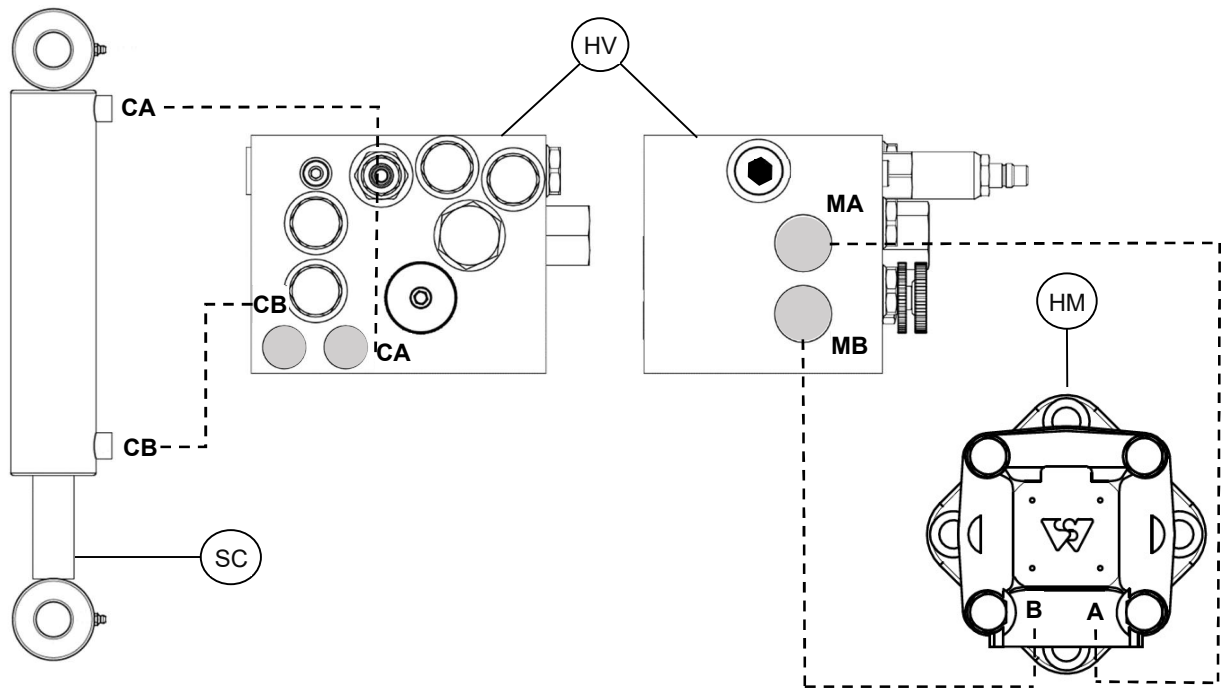

Picture.18

## 2.5 Sweeper Control - Installation



**NB!**  
Always check that the operating voltage (12V or 24V) of the solenoid coils of the hydraulic valve matches the operating voltage of the implement carrier before starting.



**Warning!**  
Remove the key from the ignition switch before connection off electrical components.



**Warning!**  
Never connect connectors to the tool carrier when they are active.

The SVX sweeper can be supplied as an option with a mounting kit (**part.nr. 2020010**) consisting of:

3-pin connector (**DIN 9680**), control box (**part.nr. 2019005**) and spiral cable 3.5m (7-pin male-male **part.nr. TKBL0895**) to connect the SVX roller brush to the tool carrier. For a functional description, see the next chapter.

1. Install the control box (A) in a safe and easily accessible location in the implement carrier. Use double-sided adhesive pads (G). Make sure that cables are not exposed to the risk of pinching.
2. Screw together bracket (B) with 7-pin connector (C).
3. Select the appropriate location on the loader arm of the implement carrier to install the coupler (B). Route and secure the cables to the tool carrier. Make sure that cables are not exposed to the risk of pinching.
4. After switching on the roller brush, connect the spiral cable (D) between the 7-pin connector (C) and (E).
5. Finally, connect the control box's 3-pin connector (F) to the electrical outlet (**min 20A**). It is important that the correct polarity is used. (31) Earth, (15/30) 12-24V See Picture.19, failure to do so will result in damage to the Hirschmann connector.
6. Picture.19 showing Mounting kit **part.nr. 2020010**

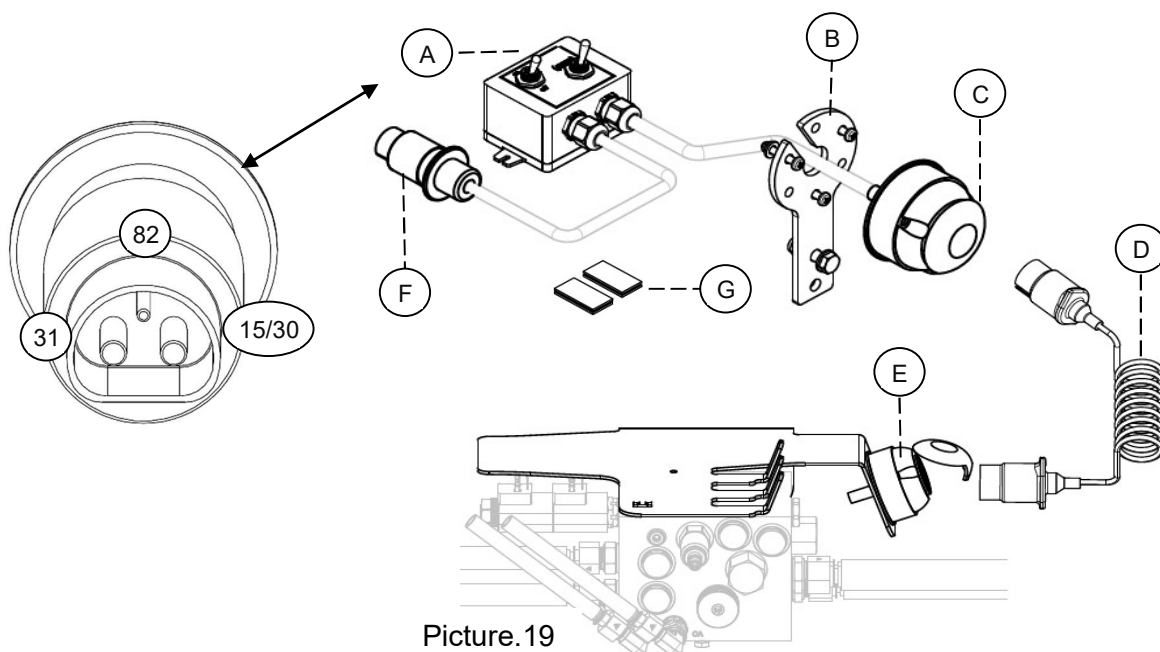

Picture.19

## 2.6 Control Box Function Description

The SVX sweeper can be supplied (recommended option) with control box (**part.nr. 2019005**).



Picture.20

Rocker switch (L) ON-OFF  
 Rocker switch (R) (ON)-OFF-(ON)

Control water pump (cable marked with **X6**), chapter 2.3.2.  
 Control turn on brush and is spring-loaded to the middle, it always reverts to neutral.

Feature description – see table below:

Symbol	Rocker switch	Function on SVX	Hirschmann Contact diode
	R – middle L – down	Turn in neutral (no valve coil activated).  Water pump off ( <b>X6</b> )	X4(CB) – off X5(CA) – off
	R – right L – down	Turn Right Activated (valve coil <b>X5</b> active — see section 2.3.2)  Water pump off ( <b>X6</b> )	X4(CB) – off <b>X5(CA) – on</b>
	R – left L – down	Turn Left Activated (valve coil <b>X4</b> active — see section 2.3.2)  Water pump off ( <b>X6</b> )	<b>X4(CB) – on</b> X5(CA) – off
	L – up	Water pump on ( <b>X6</b> ) (see chapter 2.10)	

Table: Control Box - Symbols and Functions

## 2.7 Electric diagram

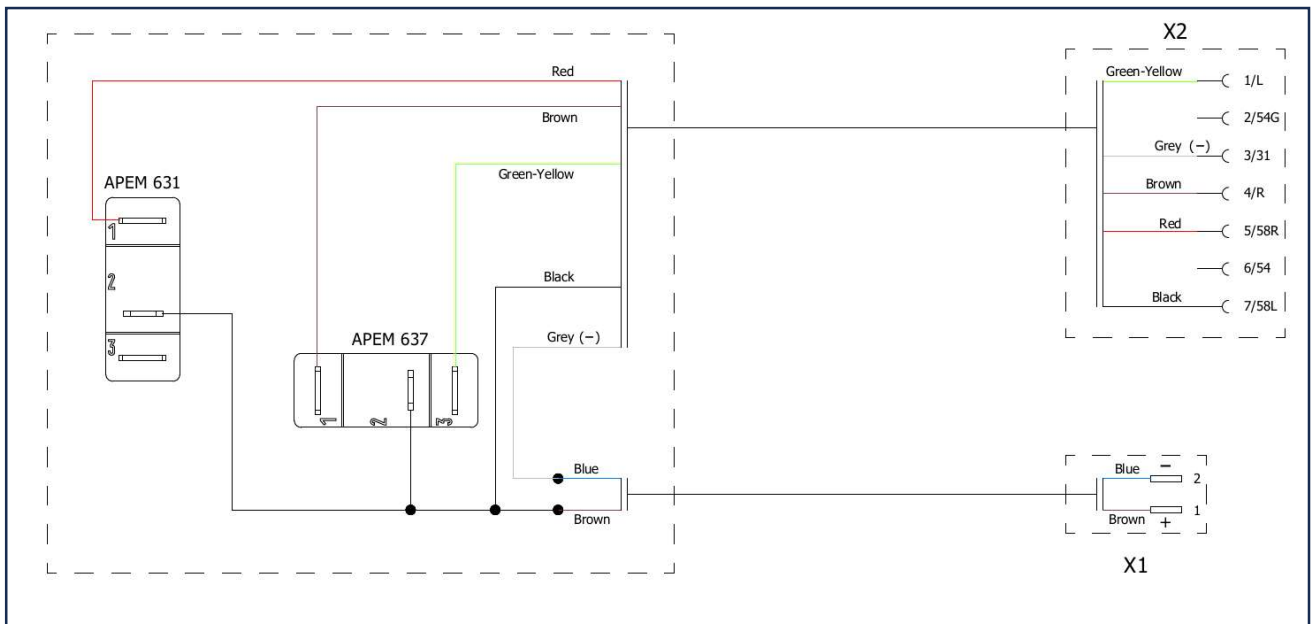

Picture.21: Electric diagram – control box part.nr. 2019005



**NB!**

An incorrect polarity of the 3-pin connector (F) (see chapter 2.5) will damage the Hirschmann X4 or X5 connector and its diodes. +12-24V is always connected to the Hirschmann connector marked 1L

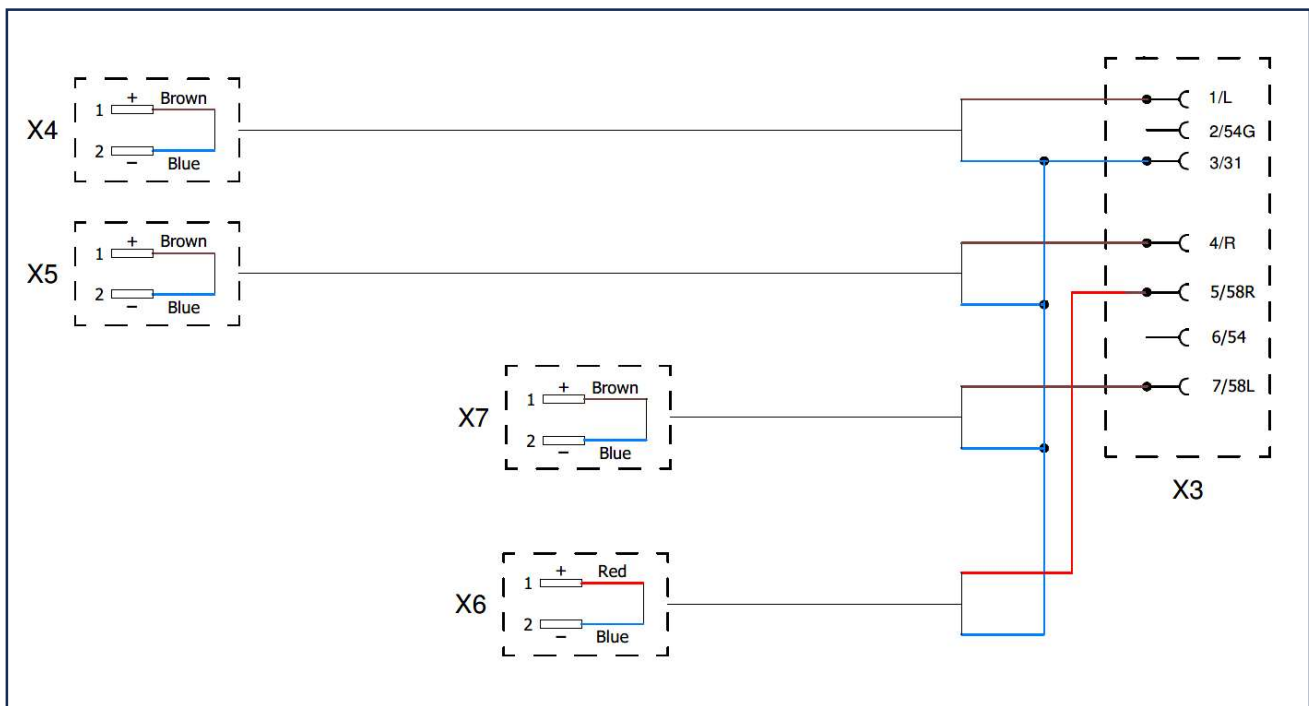

Picture.22: Electric diagram – Cable harness SVX sweeper roller part.nr. 2019004

## 2.8 Check the following before use

- 1) That the equipment is installed correctly
- 2) That all locking pins are in place
- 3) That the hydraulic hoses are connected correctly
- 4) That the hydraulic hoses are intact
- 5) Also make sure that hoses or wires do not get pinched or chafed.
- 6) Practice all the movements a few times and check that there is no oil leakage.



**NB!**

**Do not use floating mode on the implement carrier loader or front linkage.**



**NB!**

**Before sweeping, always ensure that the quick coupler (see section 2.2) is locked and that the hydraulics are connected correctly.**

## 2.8.1 Directions

The area of application for the TREJON OPTIMAL SVX sweeper is to brush sand, sanding material, leaves and to some extent also smaller amounts of snow/slush.

The operator must familiarise themselves with the sweeper in a restricted area if they are not familiar with the sweeper. This is to ensure that any incorrect movements do not result in any damage to people or property.

Brushing is done as follows:

1. Loosen the support leg and place it in the holder on the brush before you start brushing, see chapter 1.11 Picture.12.
2. Start the brush by activating the hydraulic flow and gently lower it to the ground. Refer to chapter 1.5 for correct working height.
3. The speed of the broom can be adjusted. The speed should be as low as possible, but still fast enough to sweep clean. The speed of the brush also depends on the speed of the tool carrier.
4. The speed (oil flow) is adjusted for the port marked **(MA)** by first loosening the inner locking knob **(L)** on the valve and then unscrewing the adjustment knob **(R)** to increase the speed, or screw in to decrease. When the speed is correct, the adjustment knob **(R)** is **locked** back in place with the locking knob **(L)** - see Picture.23.

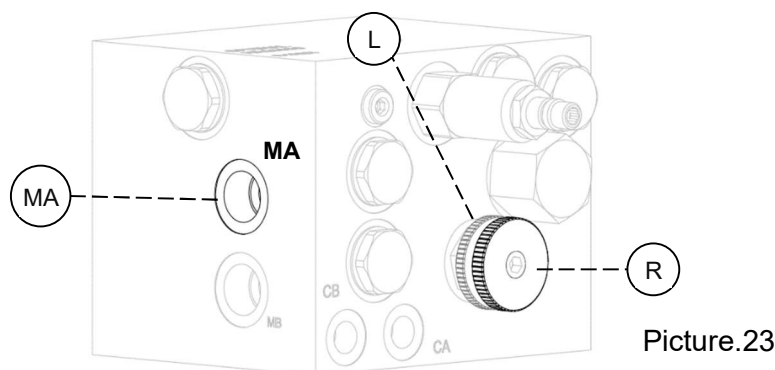

5. Make sure that there is sufficient room for movement for the brush drum in the vertical floating position both upwards and downwards. See also chapter 1.5, Picture.3.
6. The tilt/angle of the coupling frame (K) must be adjusted so that the pivot pin (ST) is vertical  $V=90^\circ$  to the ground, see Picture.24. This is to ensure that the brush maintains the same working height (h1) and pressure against the ground regardless of the angle of swivel

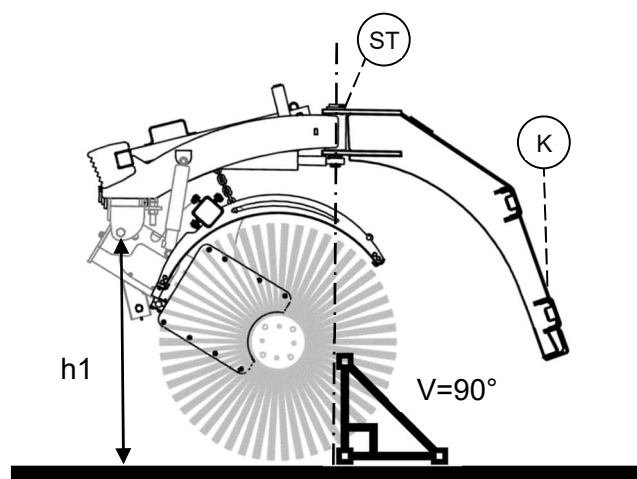

7. Do not press the brush hard against the ground, this is to avoid the lamellas to wear out very quickly and damage to the brusher. Too hard pressure on the brush against the ground, **B** shows in Picture.25.

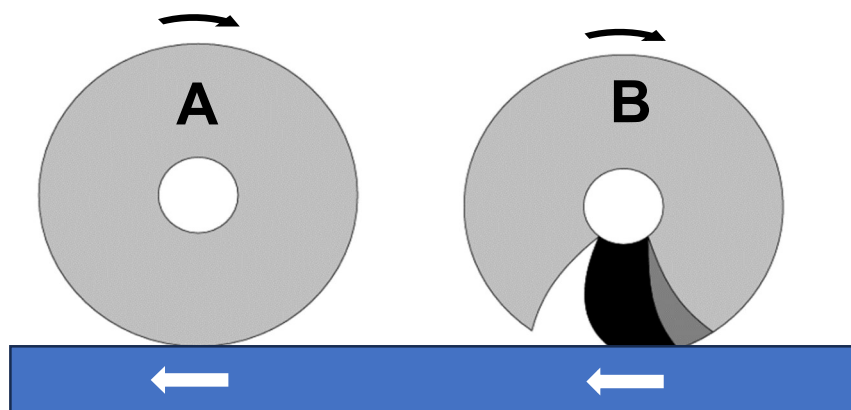

Picture.25

8. The brushing effect is best when the bristles on the slat are pressed about **1–2 cm** to the ground (**A** on Picture.25).
9. Do not point the brush at people, cars, animals, or buildings as the brush throws loose material forward. The driver is responsible for informing the surroundings, the risks and that work is in progress.

### 2.8.2 Reversing brushing (reverse direction of rotation)

The Trejon Optimal SVX broom can also brush in the opposite direction. This function can be useful when sweeping out material backwards, e.g. in front of a wall, gate or at an intersection with sensitive lawns. To rotate the broom to the opposite direction of rotation, move the tool carrier's hydraulic lever in the opposite direction. The speed of the reverse direction of rotation is fixed and can **NOT** be adjusted.



**NB! When the broom rotates in the reverse direction of rotation, the material being swept will spray/be thrown towards the tool carrier.**

The use of reverse brushing (reverse direction of rotation – see Picture below) should be seen as a temporary function to solve a minor task. The suspension of the sweeper is **NOT** adapted for this type of sweeping. In this type of driving, the operator must reduce the broom's ground pressure to prevent it from jumping.

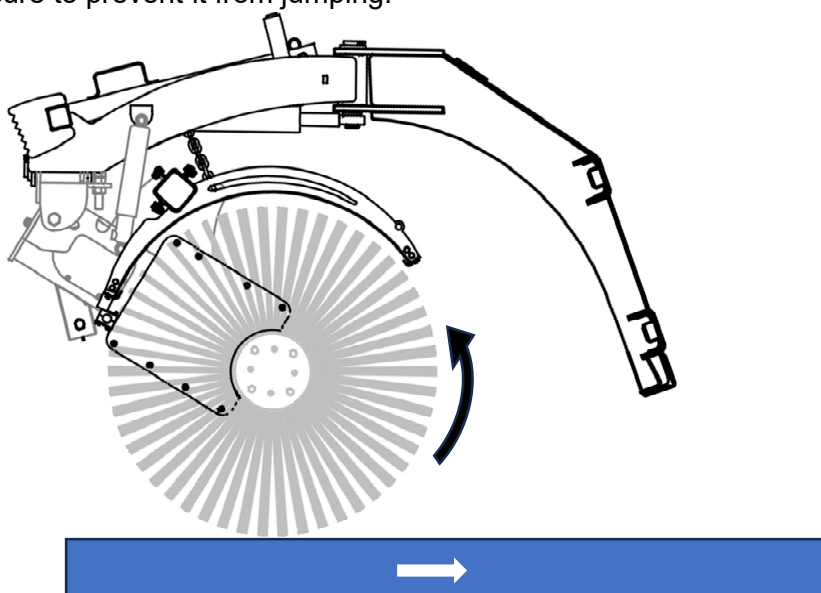

## 2.9 Overview of the irrigation system

The sweepers can be equipped with an irrigation system. This section describes the use of the irrigation system.

The irrigation system can consist of the following parts – see Picture.26 :

- Water tank (T) integrated into the machines' frame
- Water pump (P) multivolt 12-24V with Tank filter (TF), controlled by control box (optional), see chapter 2.6
- Spreader boom with nozzles (W) mounted in front of brush boom

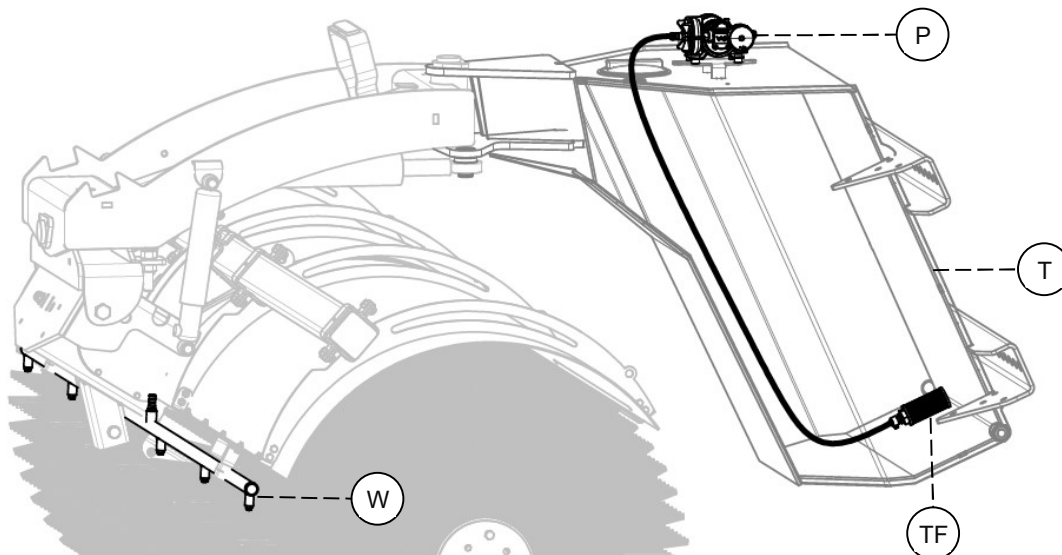

Picture.26

## 2.10 Use of the irrigation system

When you add water, this is to reduce dust when sweeping. Fill the tank with clean water. The water pump is a gear pump that can handle multivolt 12-24V DC.

In cases where you do not use the Trejon Optimal control box, you can connect the pump through an external power supply, the power requirement is 15A.

A correctly dimensioned Deutsch connector (D) is mounted on the pump (P). The corresponding connector is included (C) and is connected according to the Electrical Terminal. Picture.27; (+) to Pole 1 and (-) to Pole 2. The pump has a built-in control unit (K) to prevent it from being overloaded or running without fluid.

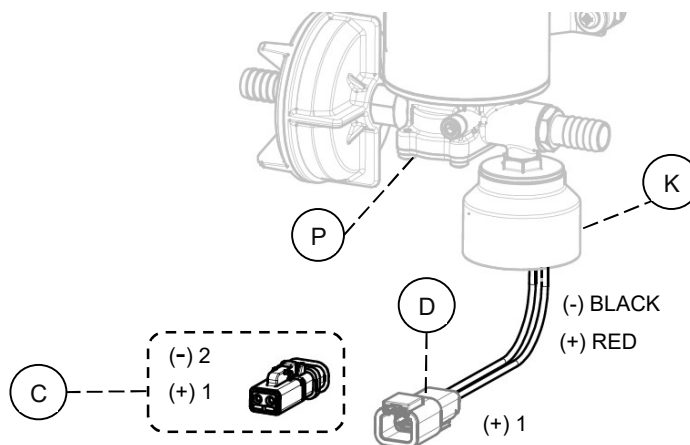

Picture.27

## 2.11 Water Pump Function Description

The water pump has a filter (F) on the incoming water and an air screw (S), see picture 28.

1. Fill the water tank completely with clean water.
2. Open the knurled air screw (S) with your fingers. Loosen the screw so that the O-ring is loose while the screw is still in the seat.
3. Activate the pump using the control box (L) or via an external switch.
4. Wait for water to fill up in the filter (F).
5. When water is squeezed out into the air screw (S), screw it in with your fingers, DO NOT use tools.

This procedure must be carried out every time the tank/pump is run empty of water. The life of the water pump and the distribution pattern of the nozzles (W) are largely determined by the use of clean water and the continuous checking and replacement of the pump's filter (F) and suction filter (TF).

Nozzle (W) code no.: **200730**

Tank filter (TF) code no.: **HR10042**

Pump filter (F) code no.: **R6400013**

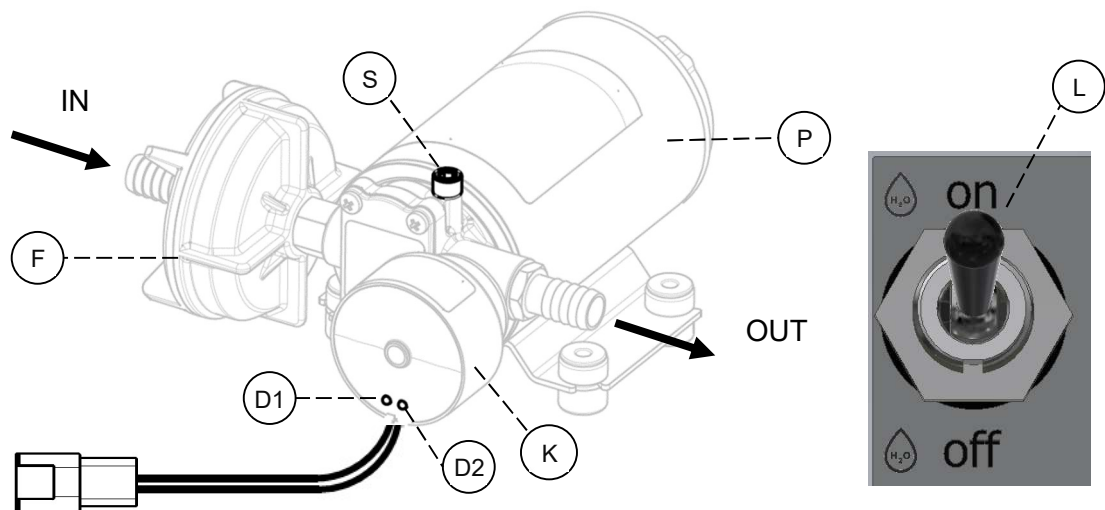

Picture.28

### 2.11.1 Status of water pump LEDs and error codes

#### Electronic Pressure Sensor (K) Job Description

The electronic pressure sensor, with the help of a microprocessor, controls the speed of the pump to obtain the required flow rate, with the following advantages:

- Noise reduction during operation
- Optimisation of current consumption
- A sharp reduction in electrical noise, thanks to the motor's slow speed ramp up and down.
- A longer service life for the entire system, due to less wear on pump parts compared to conventional mechanical pressure switches.

The pressure sensor system (K) is equipped with two LEDs, see picture below:

- (D1) **BLUE**
- (D2) **MULTICOLOR** (green, yellow and red)



Bild.29

#### D1 **BLUE** LED status:

**ON:** lights up if there is liquid in the hoses.

**OFF:** Is dark if there is no liquid in the hoses.

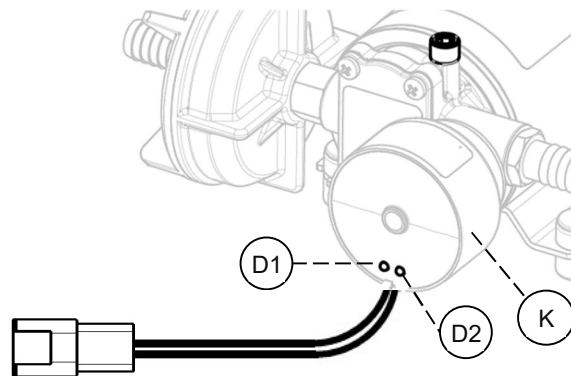
**FLASHING:** Flashes in startup mode. The first time it senses water, it will continue to flash for 10 seconds to ensure that the water is pumped correctly and continuously.

If the pump does more than five times from "starting attempt" to "no fluid" (blue LED off), the engine shuts down everything anyway, to protect the engine and gears from running without fluid.

#### D2 **MULTICOLOR** LED status:

**D2 YELLOW** With **solid** yellow LED, the pressure in the hoses has not reached the required pressure, but the pump is trying to reach it.

**D2 GREEN** With **solid** green LED, the pump has reached the target pressure, but there is still fluid need, the speed of the pump will not change because the flow is constant.

**D2 GREEN** With **flashing** green LED, the pump has reached the target pressure and there is no need for fluid, it is in standby with the engine off.

**D2 RED** With **solid** or **slow flashing** red LED, the motor has short-circuited, something may have blocked the gears, or there may be a problem in the electrical connection between the pump voltage source. The red LED will flash for 30 seconds, after which the pump will start again up to a maximum of 3 attempts.

On the fourth attempt, the LED remains solid **D2 RED**, the pump is turned off and should be checked for any permanent damage.

To reset this alert, you need to turn off the power.

**D2 RED fast flashing** LED, the pump is overloaded (due to viscous fluids or overheating of gears). While the pump is running, the speed is reduced to keep the current at the rated value for 30 seconds, after which the motor will try to increase again to normal operating speed. If an overload occurs again, the circuit tries three times to reduce the speed and it shuts down the pump. Check that the fluid being pumped is correct for the selected pump and the gears move freely without any problems. To reset this alert, you must restart the engine by cutting the power.

There are two alerts that use both LEDs:

**D2 RED** and **D1 BLUE** LEDs, **flashing alternately**, signal that the pump has been running for a minute and a half without fluid and that the engine has stopped for this reason. To reset this alert, you must restart the engine by cutting the power.

**D2 YELLOW** and **D1 BLUE** LEDs flashing together indicate too low voltage. Make sure you have the correct cable cross-section area for the power supply and a charged battery.

**D2 RED** solid and flashing **D1 BLUE** indicates that the pump has been running for more than two hours at very low speeds and the motor has been stopped to prevent overheating. To reset this alert, you need to turn off the power.

When driving during periods where there is a risk of frost, the pump must always be drained of water and filled with washer fluid that can handle the temperature, see chapter 3.4

- **The warranty does not cover damage caused from freezing!**

## 2.12 Road transport



### Warning!

Be very careful during road transport. Read the text below and do not let the brush device touch the ground during transport.

Check the condition of the sweeper before transporting. Lift the roller brush high enough to ensure that the brushes do not touch the ground. Reduce your speed if the road is uneven, a high speed can damage the sweeper.

By turning/angling the sweeper to the right side, you reduce the width of oncoming traffic but also the total transport width.

## 2.13 Disconnection of roller brush

How this is done is described in chapter 1.11

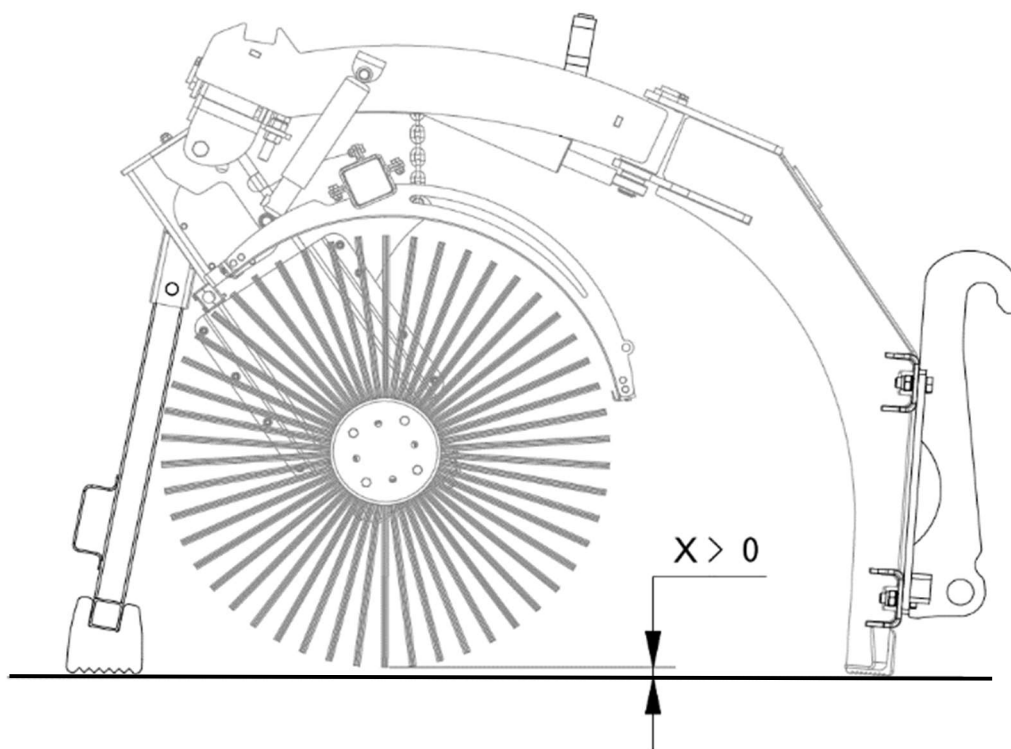

### 3 Service and Maintenance



**Warning!**

When any type of cleaning, maintenance, repair or servicing is to be carried out on the roller brush, make sure that the roller brush is lowered to the ground and the tool carrier engine is switched off. Remove the key from the ignition. Make sure that no other people are nearby who could be injured. When any type of cleaning, maintenance, repair or servicing is to be carried out on the roller brush, make sure that the roller brush is lowered to the ground and the tool carrier engine is switched off. Remove the key from the ignition. Make sure that no other people are nearby who could be injured.



**Warning!**

Never rely entirely on the tool carrier's lifting device, but use the parking stand, see chapter 1.11. Always wear protective equipment, such as goggles and gloves when performing maintenance.

#### 3.1 Generally

Maintain the machine with care to obtain cost-effective work, long service life and maintenance of the machine's value. Use only appropriate hand tools. Keep the machine clean for good operation and prevention of corrosion. Do not use a pressure washer when cleaning bearings, electrical, and hydraulic components. After cleaning the machine, lubricate the machine according to the lubrication schedule and test run for a short time.

- When maintaining or repairing the sweeper, observe all safety laws, ordinances and regulations as well as the safety instructions given in this Operator's Guide.
- Remember to reinstall any guards and safety equipment that may have been removed.
- Make sure that all the decals on the machine are in good condition after servicing. Replace damaged stickers with new ones.
- Take care of the waste oil, fluids, filters and replaced vanes and take them to the disposal facility.
- Do not spill oil or liquids on the ground but take care of your surroundings.

Use the table below for the correct tightening torque for bolted joints on the machine.

Diameter	Class 8.8		Class 10.9	
	Nm	lb.ft.	Nm	lb.ft.
M8	25	18	35	26
M10	50	37	70	52
M12	90	66	125	92
M14	140	103	200	148
M16	215	155	305	225
M18	295	217	420	309
M20	420	302	590	438
M22	520	380	730	535
M24	670	490	940	690

When locking nut is used, increase the torque 5 %.

Table - Tightening torques for bolted joints.

## 3.2 Maintenance schedule

### After the first 4 hours of operation:

- Check and retighten screw connections on the machine to ensure a correct first connection to the tool carrier.

### Daily service 8 hours of operation

- Check the wear of the lamellas/slats.
- Check that there are no leaks from the hydraulics and that the hoses are in good condition.
- Check the general mechanical condition of the brushing machine.

### Weekly service 40 hours of operation

- Check that the fastening bolts on the adapter are properly tensioned and tighten them if necessary.
- Lubricate all lubrication points in accordance with chapter 3.11.

### Weekly service 80 hours of operation or annually

- Check the tension and condition of the drive chain. NEVER shorten a chain if the tension is not sufficient, in this case replace the chain according to chapter 3.8.
- Check the wear of the wear plates chain housing.

Service point	Interval	Measure	Lubricant	Remark
Quick coupler Bolted joints	First 4h then was 8h	K/J		M20 – 420Nm; M16 -215Nm See chapter 1.8
Bolted joints	First 4h then was 40h	K/J		
Brush slats	8h	K/J		Check wear, replace if necessary. See chapter 3.9
Hydraulic hose	8h	K		Check wear, replace if necessary.
Lubrication points	40h	K	Grease NLGI 2	See chapter 3.11
Shock absorber	40h	K/J		See chapter 1.6
Drive chain	80h / yearly	K/J		Check tension, change if necessary. See chapter 3.6; 3.7; 3.8
Wear plates chain drive housing	80h / yearly	K		Check wear, replace if necessary.
Oil-level chain drive housing	80h / yearly	K/B	Shell Omala S2 GX	
Boundary chain with shackle	80h / yearly	K		Check wear, replace if necessary.

### \*Action codes: J=Adjustment, K=Control, R=Cleaning, B=Replacement

When lubricating, use NLGI 2 grease with good quality EP properties that can withstand low temperatures. Do not use so-called "graphite grease" for ball bearings. Pneumatic grease guns must not be used for lubrication of sealed bearings, as the seal may come loose or be damaged. Clean the grease fittings before applying the grease gun.

These intervals are in normal driving, in continuous driving lubricate more often. Always lubricate with water after cleaning.

### 3.3 Before the start of the season

All the above points – see section 3.2 – should be reviewed. If the machine is properly serviced, this will result in a significantly longer service life and more carefree operation.

### 3.4 After the end of the season

It is recommended that the user take at least the actions mentioned in section 3.2. after the sweeping season.

The roller brush must be cleaned thoroughly, then lubricated and serviced. Replace worn or damaged parts. When the machine is dry, it is recommended to apply a thin layer of oil to the areas where the paint has worn off.

Avoid flushing high-pressure water towards the irrigation pump.

The piston rods of the hydraulic cylinders must be cleaned and then oiled.

The device should preferably be stored under a roof in a dry place.

Electrical connectors can be lubricated with contact spray.

**For sweepers equipped with tanks or irrigation systems, it is important that the following are strictly adhered to:**

Remember to empty the tank after use and fill/suck or refill it with washer liquid with correct level of antifreeze (this must be done the better option) if it is stored in temperatures lower than +1 degrees!

#### **Emptying instructions:**

Open the drain plug at the bottom edge of the water tank.

Activate the pump, see Picture 28 until water no longer comes out of the nozzles.

Switch of the pump.

Pull up the suction filter with the hose from the tank.

Fill a bucket with washer liquid correct level of antifreeze and put the filter in the bucket.

Activate the pump, open air screw on pump if necessary and wait until washer liquid enter the nozzles.

Empty the water tanks before winter storage! The water expands when it freezes, causing the container to swell and possibly crack. This kind of damages is NOT covered by warranty.

### 3.5 Oil change– chain drive housing

The SVX Chain Drive Housing (H) is filled with oil to lubricate the chain. The house will be filled with **Shell Omala S2 GX** or equivalent oil. The correct amount is 0.7 L. The oil level is checked by plug (P2) – see Picture.30.

Changing the oil:

**Step 1:** Set the machine down to the ground in accordance with chapter 1.11.

**Step 2:** Place a container under the chain drive housing (H) to collect the replaced oil.

**Step 3, Picture.30:** Open plug (P1) and plug (P2).

**Step 4:** Make sure that all the oil is collected in the container. Check the quality of the oil. Large pollutants or metal particles in the oil are not normal. If this is the case, the cause must be investigated.

**Step 5, Picture.30:** Reassemble the plug (P1).

**Step 6, Picture.30:** Fill up with oil, 0.7L and reinstall the plug (P2).

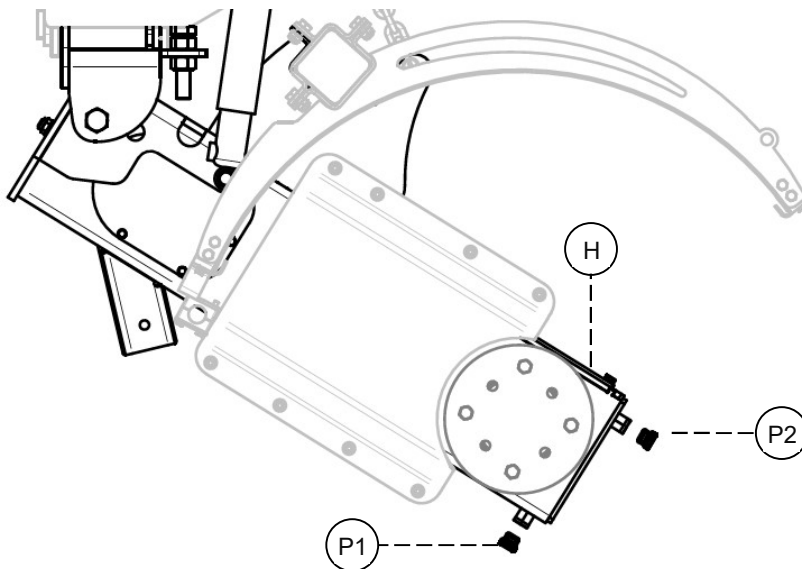

Picture.30

Oil should be changed annually, see chapter 3.2

### 3.6 Inspection and maintenance of the chain.

The sweeper is powered by the hydraulic motor and a chain transmission. After one's time of driving, the chain will become longer. It is necessary to check and tighten the chain according to the guide below.

**Step 1, Picture.31:** Unscrew the cover (L1).

**Step 2, Fig.32:** The tension of the chain is checked by pressing the chain. With light pressure on the chain (K) it should be able to be moved (X) about 2-3 mm.

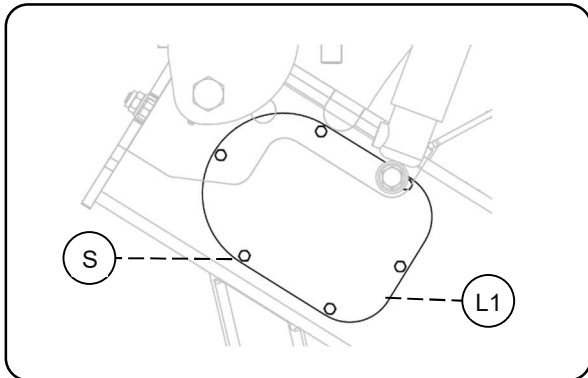

Picture.31:

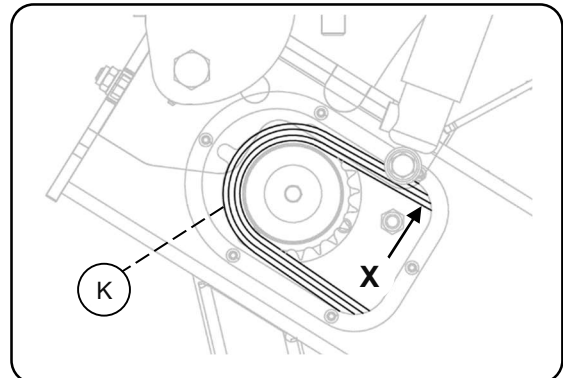

Picture.32:

### 3.7 Adjusting the chain tension

**Step 1, Picture.33:** Loosen the lock nut (N1) approx. 15mm then loosen 4 screws (SM) approx. 3mm.

**Step 2, Picture.34:** Screw in nut (N2), screw (T) will move the motor console (P).

**Step 3, Picture.32:** Check that the correct chain tension approx. 2-3 mm (X) is achieved.

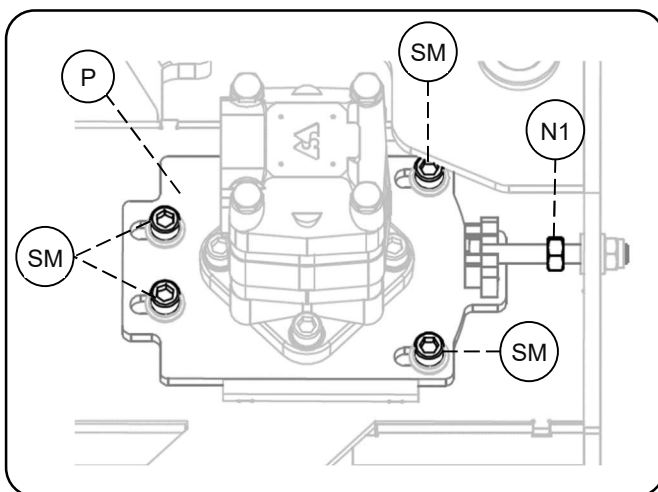

Picture.33

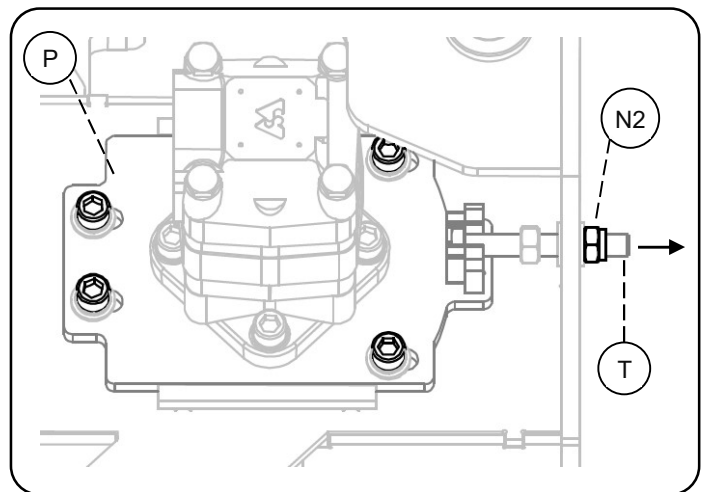

Picture.34

**Step 4, Picture.35:** Screw in the jam nut (N1) and hold the nut (N2).

**Step 5, Picture.35:** Tighten 4 screws (SM).

**Step 6, Picture.31:** Reassemble the cover (L1).

### 3.8 Replacing the chain.

**Step 1:** It may be helpful if the brush slats are first removed on the left-hand side, see chapter 3.10

**Step 2: Picture.36:** Removing the cover (L1) and (L2).

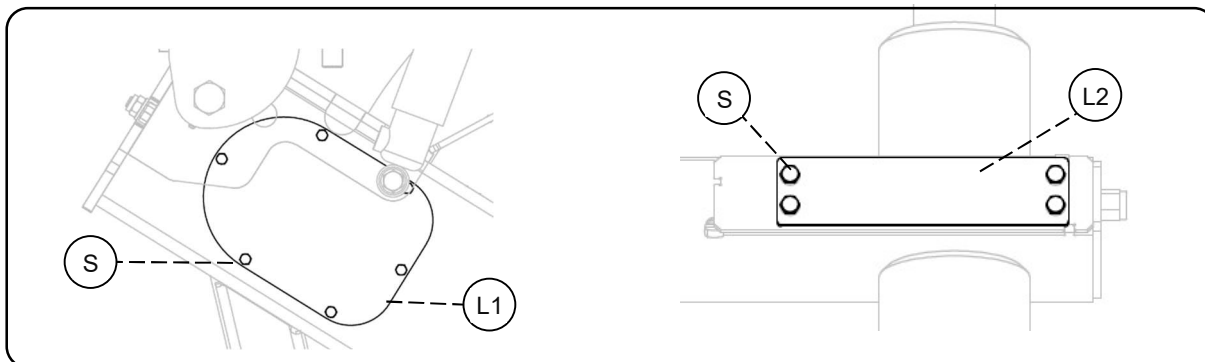

Picture.36

**Step 3, Picture.37:** Loose lock nut (N1) approx. 15mm then loosen 4 screws (SM) approx. 3mm.

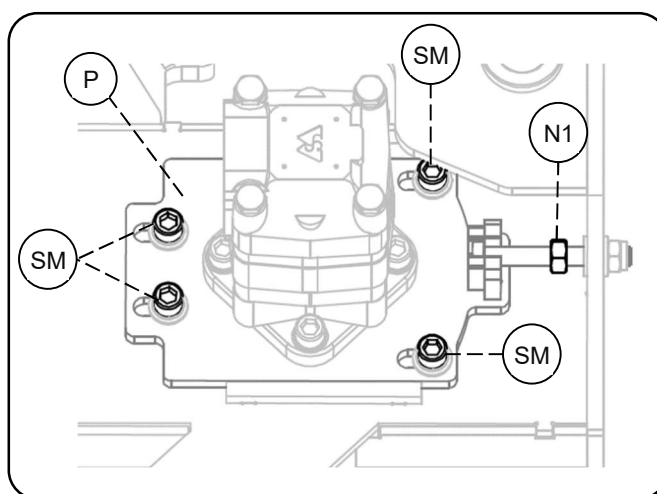

Picture.37

**Step 4, Picture.38:** Loosen nut (N2) approx. 15mm, move the motor bracket (P) in the direction of the arrow so that the chain slackens.

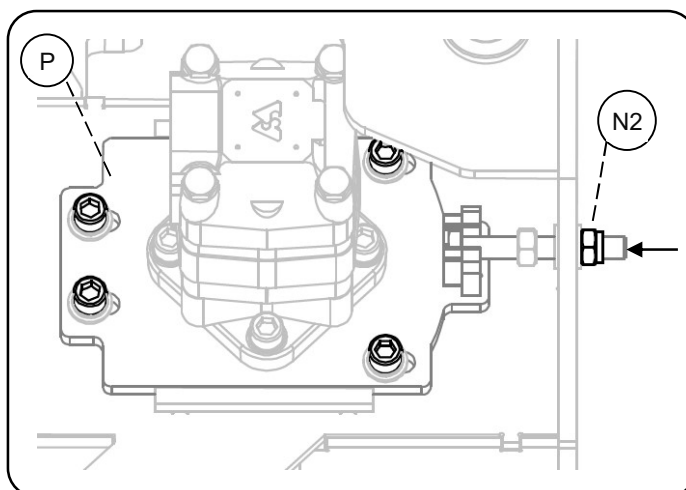

Picture.38

**Step 5, Picture.39:** Turn the chain (K) forward so that the chain lock (KL) is visible in the upper opening.

**Step 6:** Remove the lock washer, remove the chain lock and attach a wire/cable to the chain. Pull out the chain and let the wire/cable follow around the lower shaft of the chain housing.

**Step 7:** Remove the chain (K) from the wire and attach the new chain to the wire. Pull the new chain through. This can be facilitated by gently rotating the brooms at the same time - **Risk of pinching!**

**Step 8, Picture.39:** Connect the chain with a new chain lock. Note the correct mounting direction on the chain lock (KL).

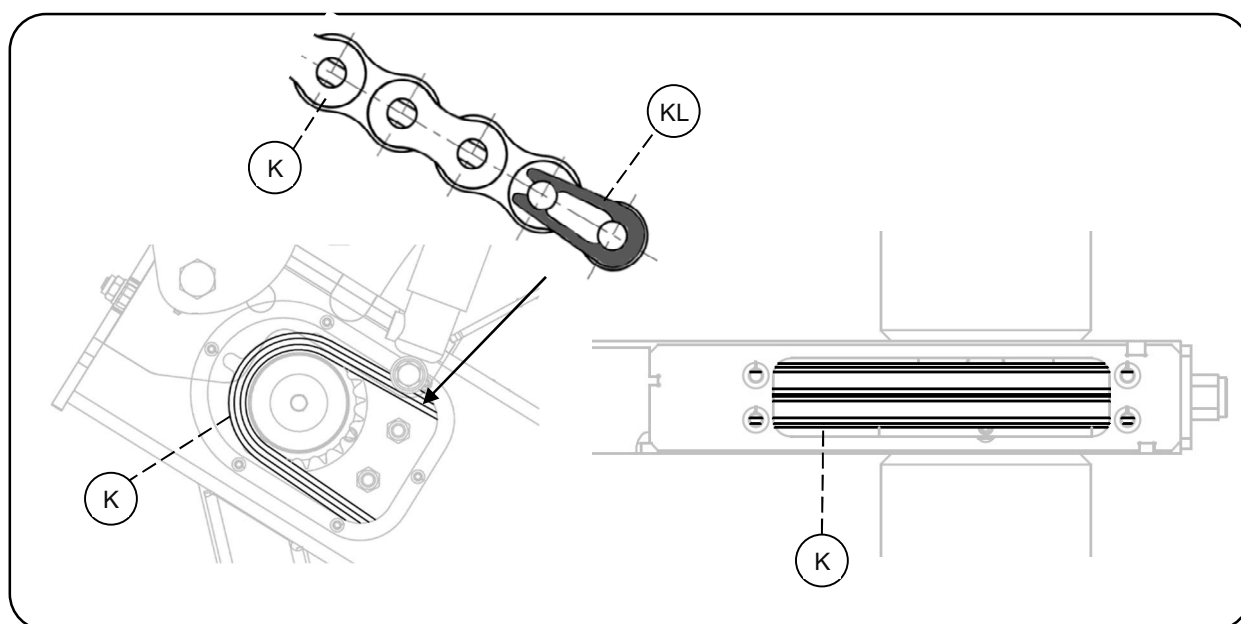

Picture.39

**Step 9:** Always adjust chain tension according to chapter 3.7 after replacing the chain.

**Step 10, Picture.36:** Reinstall cover caps (L1) and (L2).

### 3.9 Changing lamellas

Dismantling worn slats – see Picture.40.

**Step 1:** Remove the screws (S) and cover cap (E).

**Step 2:** Remove all brush blades and spacers (C) from the brush drum (B).

**Step 3:** Clean and check the condition of the brush drum (B).

**Step 4:** Also check the condition of the spacers (C), worn or broken spacers are replaced.

Installation of new slats

**Step 1, Picture.40:** Place the first lamella (D) on the brush drum (B) in such a way that the drive teeth (T1) of the lamella are positioned vertically according to point 1.

**Step 2, Picture.40:** Place a spacer (C) on the brush drum, slide it towards the lamella (D).

**Step 3, Picture.40:** Place the second lamella (D) on the brush drum (B) so that the drive teeth (T2) on lamella are positioned horizontally, i.e. turned 90° from the previous disc, according to point 2.

**Step 4, Picture.40:** Place a new spacer according to step 2.

**Step 5, Picture.40:** Place the third lamella (D) on the brush drum (B) in such a way that the drive teeth (T2) on the lamella are positioned vertically, i.e. turned 90° from the previous disc, according to paragraph 3.

**This is an important measure to get a good balance and allow for a correct preload.**

**Step 6, Picture.40:** Repeat **Step 1...Step 5** until all lamellas are aligned.

Read the next page for completion of installation and description of the correct number of lamellas.

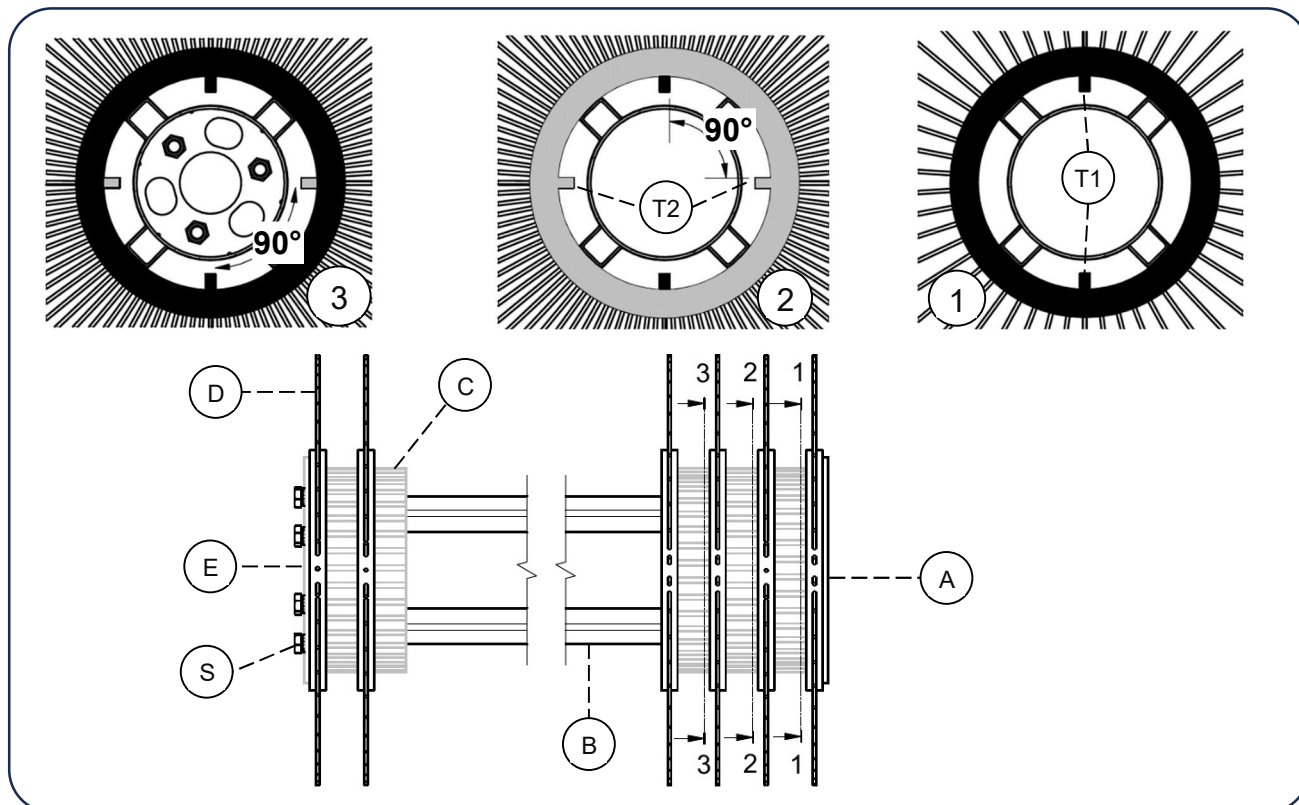

Picture.40

**Step 7, Picture.41:** When the last lamella (D1) is placed, it will protrude about 20mm (X) outside the brush drum (B). If the distance (X) is not correct, you can mount a lamella (D2) without a spacer act. **ALT2.**

**Step 8, Picture.42:** Place the cover cap (E) on the outside together with the screws (S). Tighten the screws alternately until the clearance (X) reaches 0mm and the cover cap reaches the end of the brush drum (B).

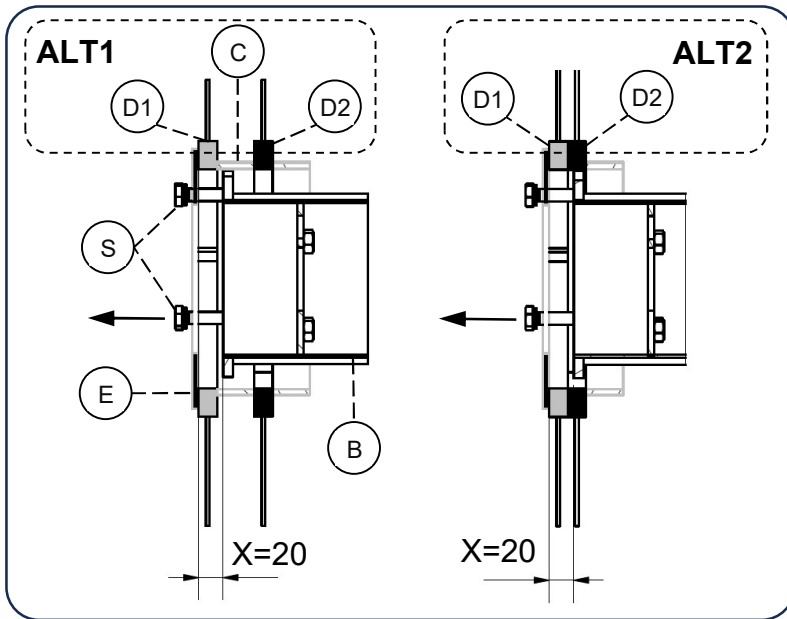

Picture.41

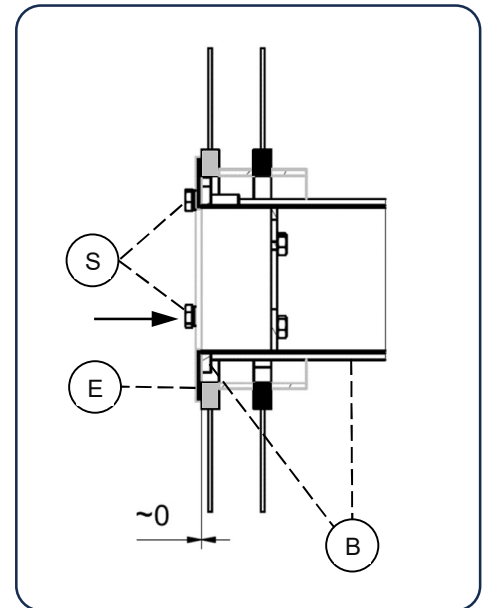

Picture.42

The table below shows the number of lamellas (D) and spacers (C) for each model of SVX machine when new spacers are fitted.

Modell	SVX250	SVX280	SVX300	SVX330
<b>C – Distance 7”x30</b> Part. nr <b>SOP980006</b>	<b>52</b>	<b>60</b>	<b>66</b>	<b>72</b>
<b>D – Lamellas ø900</b> Part. nr <b>SOP980045-2</b>	<b>54</b>	<b>62</b>	<b>68</b>	<b>74</b>

### 3.10 Removing the brush drum

The brush drum does not need to be removed except in the event of a collision or in connection with major maintenance of the drive unit, such as replacing the drive unit bearings/seals or replacing the sprockets.

Remove the lamellas from the roller brushes, see chapter 3.9.

**Step 1, Picture.43:** Remove the screw (S) that locks the brush drum to the drive shaft (A)

**Step 2, Picture.44:** Using two pry bars (T), place them between the flange of the brush drum (D) and the chain housing (H), press and break the brush drum from the drive shaft.

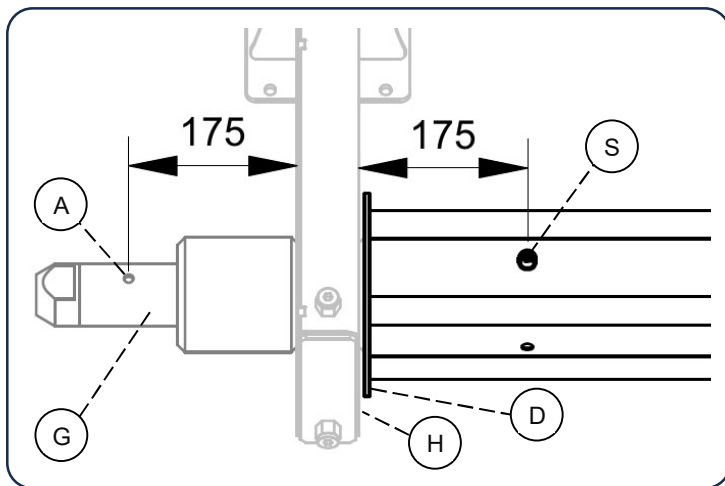

Picture.43

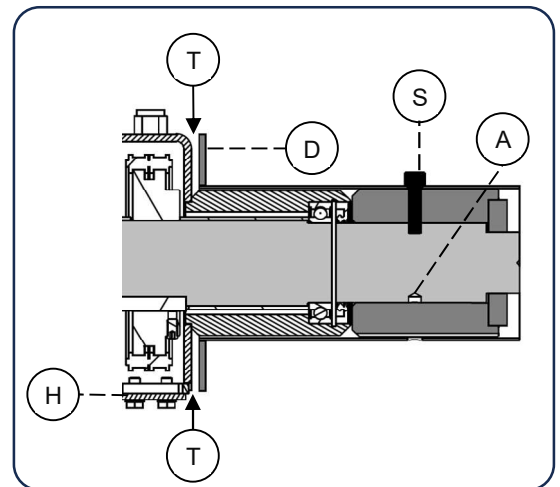

Picture.44

#### Reassembling

**Step 3, Picture.43:** Clean the surface of the drive shaft (G) from dirt and rust.

**Step 4, Picture.43:** Brush the drive shaft (A) with grease (see chapter 3.9) onto the surface (G).

**Step 5, Picture.43:** Reinstall the brush drum until the screw hole is approx. 175 mm from the chain housing (H).

**Step 6, Picture.44:** Fix the brush drum by reassembling the screw (S) on the brush drum.

### 3.11 Lubrication Points - Placement

Nipples marked with (X) on Fig.45 should be lubricated every 40 operating hours or weekly. Pump grease into the storage until it comes out at the side of the bearing, wiping off the excess.

Some well-known brands of fat that can be used to advantage:

Shell - **SRS 4000**; Esso- **Thermo 30150**; Statoil - **Grease Way CAH92**; Hydro Texaco - **Hydex EP2**

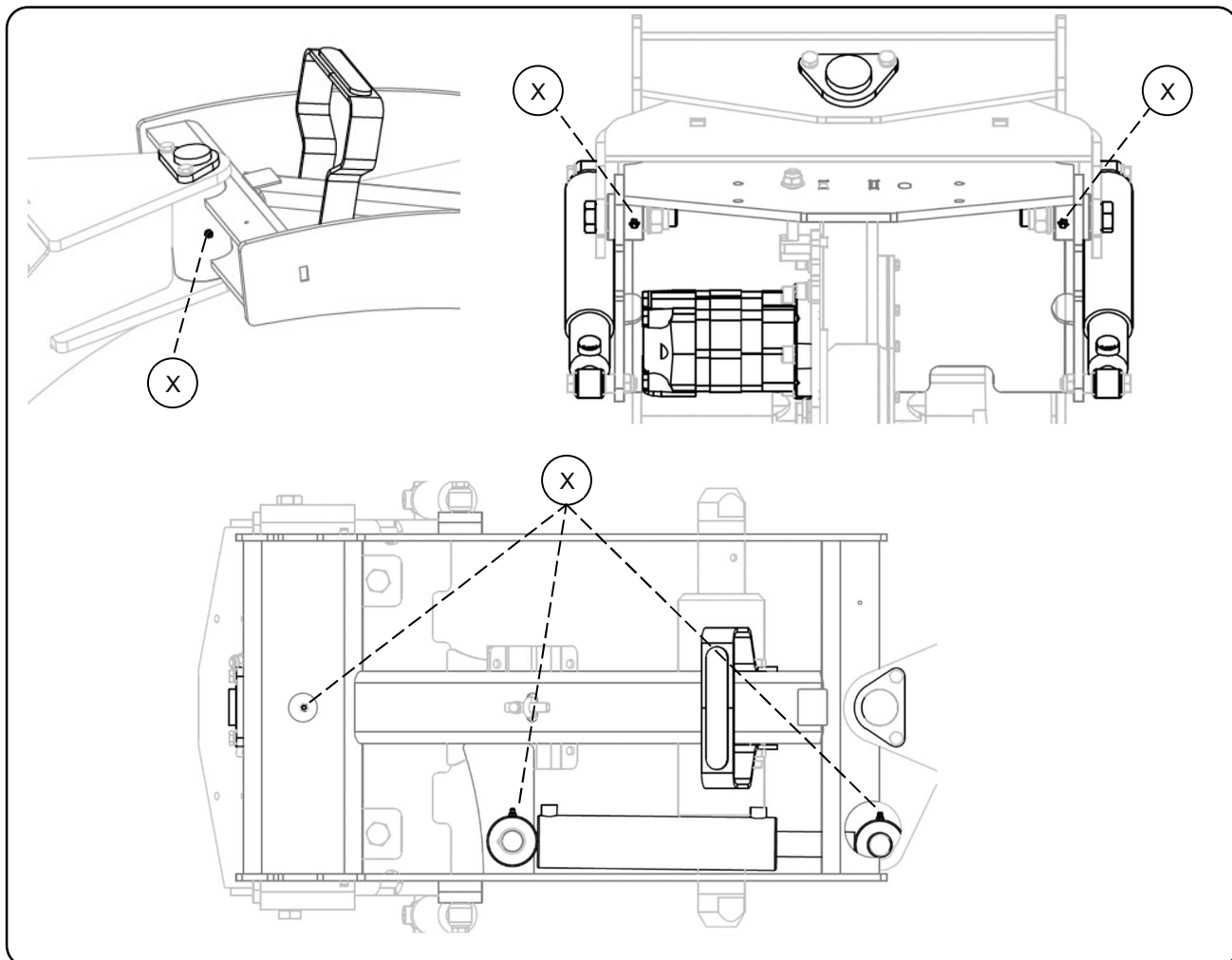

Picture.45: SVX Lubrication Points Overview

## 4 Spare parts

### 4.1 Use original spare parts

You are faced with the choice between "original" or "copy"! The choice is often determined by the price. A "cheap" purchase can end up costing you dearly.

A few reasons to choose TREJON Original parts:

- Quality & Fit
- Reliable operation
- Longer service life and thus better economical operation
- Guaranteed availability through TREJON's sales partners

TREJON Genuine Parts and Accessories are designed specifically for these machines. The assembly and/or use of non-original parts and accessories may adversely alter the technical characteristics of your machine. The manufacturer does not provide any warranty for damage caused by the non-use of original parts or accessories.

The warranty does not cover arbitrary modifications made to the machine.

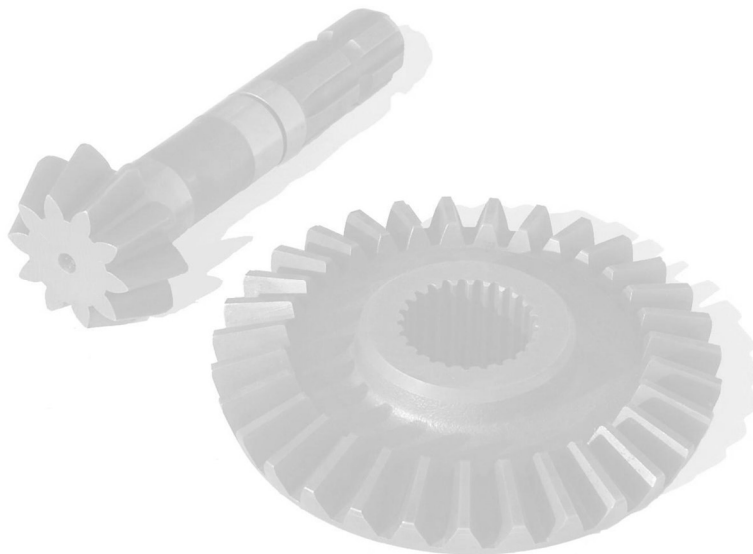

Contact the dealer where you bought the machine, when you need spare parts or other service. When ordering spare parts, always find out the correct model, type and serial number refer to the machine plate placed on the chassis.

# EC certificate of conformity

according to EC standard 2006/42/EC

TREJON FÖRSÄLJNING AB  
SE – 911 35 Vännäsby, Företagsvägen 9

declare with sole responsibility that the following product,

TREJON OPTIMAL brush sweeper

SVX250; SVX280; SVX300; SVX330  
SVX250W; SVX280W; SVX300W; SVX330W

(make, type)

for which this certificate applies, complies with the current basic safety and health protection regulations in accordance with EC Standard 2006/42 / EC, and also meets the requirements of other applicable EC standards.

— — —

The following standard(s) and/or technical specification(s) have provided the basis for the professional introduction of the safety and health regulations set out in the EC standards:

EN ISO 12100-1 : 2010    EN ISO 12100-2 : 2010



Henrik Johansson  
CEO

Vännäsby, 01.05.2021

Issued (place/date)

(Name, position and signature of authorised employee)

## 5 Guarantee assignment certificate

### Guarantee- /assignment certificate

- Guarantee terms** - Valid between retailer (Trejon AB dealer) and machine purchaser.
- General about guarantee** - In order to obtain valid guarantee terms set forth below, and the specific guarantee terms set by each provider. These are attached to the user manual for each machine, as appropriate.
- Validity of guarantee** - The guarantee is 12 months from date of purchase.  
In some cases, the guarantee can be limited by running time.
- The guarantee covers** - Damaged parts, which have broken down because of defective production operations of materials in course of normal use of the machine.  
- Only the labor cost for replacement of defective warranted part.
- The guarantee does not cover** - Transport costs applicable to the machine or the parts.  
- Travel costs.  
- Any resulting costs incurred as a result of damage to the machine.  
- If the machine has been modified by the owner.  
- Damage due to normal wear and tear of the machine – Not related to manufacturing defects, poor service, user inexperience or use of spare parts that are not original.  
- Excessive or inappropriate use of the machine.  
- The guarantee is not applicable to parts which are subject to wear, for example hoses, sealing, oil, belts, batteries, chains, knives etc.  
- The guarantee period for replaced parts during the guarantee period expires with the machine's guarantee.  
- Normal adjustments, maintenance or supervision
- Guarantee procedures** - Contact place of purchase as soon as any damage or malfunction is detected.  
Do not use the machine if the damage can be worse.  
- Guarantee repairs must be performed by Trejon AB approved workshop.

**ATTENTION!** The guarantee shall enter into force provided that the machine **GUARANTEE/ ASSIGNMENT CERTIFICATE** has been fully completed and signed by both parties (archived by the seller), and recorded on the Trejon web portal no later than 14 days from date of sale (the seller is responsible for this happening).

**Assignment certificate:**

Machine Buyer shall confirm with his signature that he had received manual containing operating instructions, and received information about the operating, security and maintenance requirements described in this and made the final inspection of the machine.



PLEASE FILL IN!

Product: \_\_\_\_\_ Serialno. \_\_\_\_\_

Salesman: \_\_\_\_\_ Company: \_\_\_\_\_

Signature of salesman: \_\_\_\_\_ Date of purchase: \_\_\_\_\_

Name of buyer: \_\_\_\_\_ Telephone: \_\_\_\_\_

E-mail: \_\_\_\_\_

Address: \_\_\_\_\_ Zipcode: \_\_\_\_\_

City: \_\_\_\_\_ Country: \_\_\_\_\_

Date: \_\_\_\_\_ Signature of buyer: \_\_\_\_\_

*We store personal data, see our privacy policy: <https://www.trejon.se/enu/Dataskyddspolicy/>*

TREJON AB reserves the right to change or improve the displayed models with technical or commercial justifications, without the requirement to implement the changes on already delivered machines. Pictures in the manual do not necessarily show the machine that has been delivered.

Technical data, weights and dimensions are non-binding. All rights reserved.

© 2024 Trejon AB, Sweden

Reprinting, translation and excerpts may only be carried out with the written permission of

TREJON AB, Företagsvägen 9, SE – 911 35 Vännäsby.

All rights under copyright law are reserved.



**TREJON FÖRSÄLJNING AB**

Företagsvägen 9  
SE-911 35 VÄNNÄSBY  
SWEDEN  
Tel: + 46 (0)935 39 900  
Webb: [trejon.se](http://trejon.se)